

1. Exploded View & Part List

Exploded View

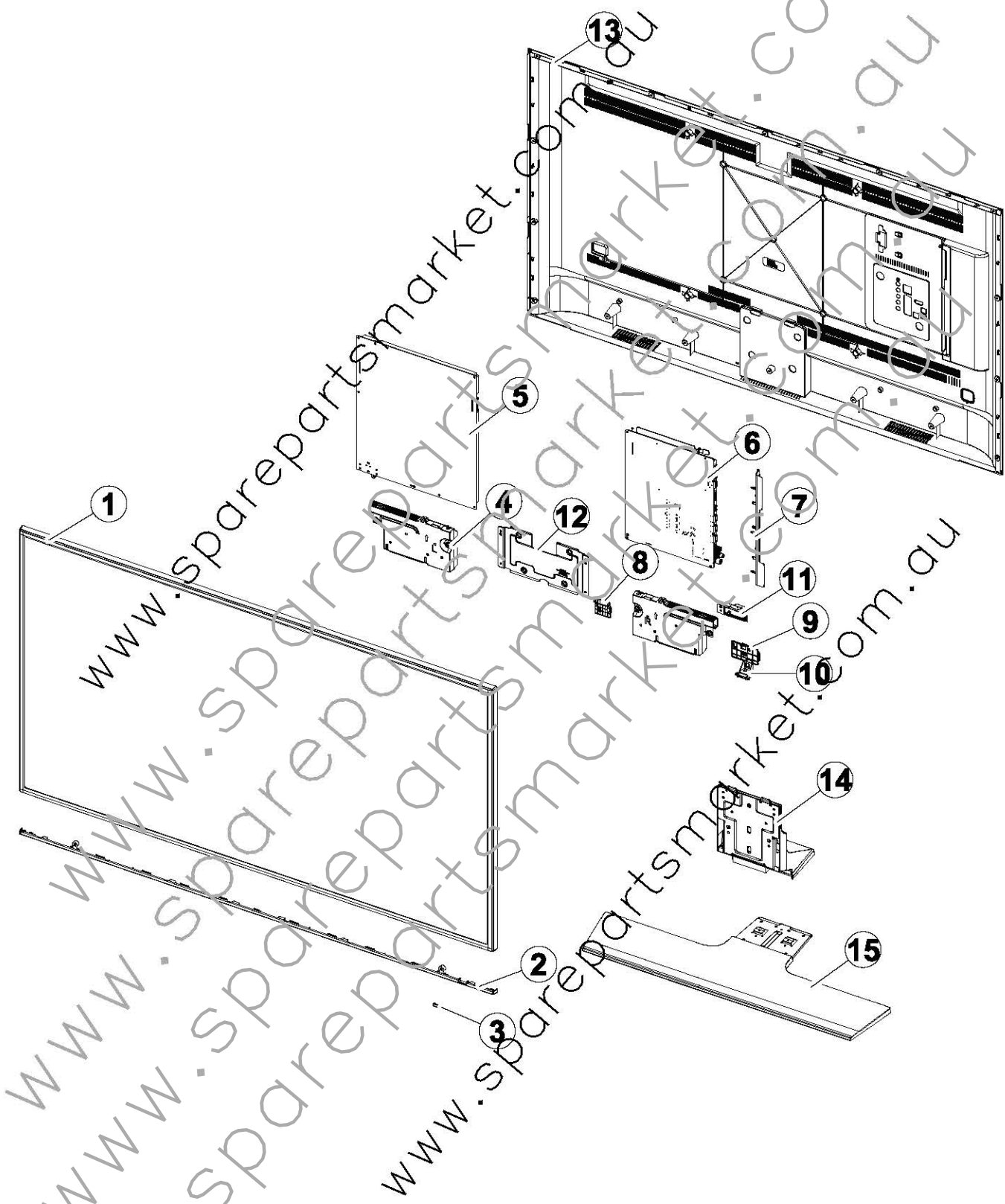

Parts List

No.	Lvl.	Loc.	Material Code	Description & Specification	SNA	Qty.
1	2	PANEL	BN95-01607A	PRODUCT LCD-INX; V500DK2-QS1,CY-GH050HGNV	SA	1
2	2	CD01A	BN95-01711A	ASSY DECORATION,SMT; HU7000,50 LIGHT TITA	SA	1
3	2		BN63-12221A	COVER-IR; HU7000,PC	SA	1
4	2	SP01A	BN96-31842E	ASSY SPEAKER P; 6ohm,10W,Enclosure_UH7k	SA	1
5	2	P001A	BN44-00755A	DC VSS_UHD PD BD; L55N4_ESM,L55N4_ESM.AC/	SA	1
6	2	M0014	BN94-07582B	ASSY PCB MAIN; HU7000	SA	1
7	2		BN61-10507A	HOLDER-SIDE AV; HU8500,HIPS,1TUNER	SNA	1
8	2	BT	BN96-30218A	ASSY BOARD P-RF-MODULE; Bluetooth Module,	SA	1
9	2	WIFI	BN59-01174A	NETWORK-WIFI MODULE; WIDT-30Q,Internal Wi	SA	1
10	2	IR	BN96-32173A	ASSY BOARD P-UHD7K IR FUNCTION; UHD_NT14U	SA	1
11	2	JOG	BN96-32172A	ASSY BOARD P-UHD7K SW FUNCTION; UHD_NT14U	SA	1
12	2	SB05A	BN96-32406A	ASSY BRACKET P-STAND LINK; 40, 50HU7000,H	SNA	1
13	2	R001A	BN96-33672A	ASSY COVER P-REAR; HU7000,50,HIPS V0,BLK	SA	1
14	2	SB02A	BN96-32240A	ASSY STAND P-NECK; 50",55" HU7000,PC+ABS,	SA	1
15	2	SB04A	BN96-32239A	ASSY STAND P-BASE; 50",55" HU7000,PC+ABS,	SA	1

2. Electrical Parts List

Level	Loc.	Part Code	Description & Specification	Qty.	SA/SNA
			UA50HU7000WXXY (IS01)		
1		BN90-05367A	ASSY W/I;HC7000	1	SNA
.2		BN81-08159Z	PART SET-ELEC W/I;UF4-UF8,UH4,UH9 ELEC	1	SNA
.2		BN81-09498S	PART SET-MECH W/I;UH7R,U50MR*	1	SNA
1	S001A	BN90-05378A	ASSY STAND;HC7000	1	SNA
.2	SB04A	BN96-32239A	ASSY STAND P-BASE;50",55" HU7000,PC+ABS,	1	SA
..3	SCREW	6003-000131	SCREW-TAPTYP;BH,+,S,M4,L6,ZPC(BLK),SWRC	2	SNA
..3	SCREW	6003-001010	SCREW-TAPTYP;FH,+,B,M3,L6,ZPC(WHT),SWRC	4	SA
..3		6902-002085	BAG PE;HDPE/PE FOAM,T0.015/T0.5,W800,L20	1	SNA
..3		6902-002092	BAG PE;HDPE/PE FOAM,T0.015/T0.5,W180,L16	1	SNA
..3		BN01-00178A	COMPOSITE PANEL;HU7000,COMPOUND PANEL,T5	1	SNA
..3		BN61-04692A	BOSS-PRIMER;#94,SHEET,clear,35cps	0	SNA
..3		BN61-10592A	BRACKET-BOTTOM LINK;HU7000,HGI,T1.0	1	SNA
..3		BN63-12219A	COVER-STAND BOTTOM;HU7000,ABS+PC	1	SNA
..3		BN64-02669A	BADGE-INLET,HU8500,Ni,0.05,black chrome,	1	SNA
..3	M0019	BN73-00052C	RUBBER-FOOT;LCD TV,Silicone RUBBER,T2.0	7	SNA
..3		BN96-32746B	ASSY ACCESSORY-SCREW;HU7000,40,6001-001	1	SNA
...4		6001-001961	SCREW-MACHINE;FH,+,M4,L12,ZPC(BLK),SWRCH	6	SA
.2	SB02A	BN96-32240A	ASSY STAND P-NECK;50" 55" HU7000,PC+ABS,	1	SA
..3	SCREW	6003-001208	SCREW-TAPTYP;BH,+,S,M4,L12,ZPC(BLK),SWR	1	SA
..3	SCREW	6003-001785	SCREW-TAPTYP;FH,+,B,M4,L8,ZPC(BLK),SWRC	2	SA
..3	SCREW	6003-004819	SCREW-TAPTYP;CH,B,M3,L6,ZPC(BLK),SWRCH1	1	SA
..3		6902-002059	BAG PE;HDPE/PE FOAM,T0.015/T0.5,W300,L40	1	SNA
..3	AH089	BN61-10505A	HOLDER-CABLE;HU8500,ABS,HB	1	SNA
..3		BN61-10591A	BRACKET-NECK;HU7000,HGI,T3.0	1	SNA
..3	AS080	BN63-04755G	SHEET-COVER;42PC450,PE,T0.05,W250mm,L300M	1	SNA
..3		BN63-12050A	COVER-NECK-FRONT;HU8500,ABS,HB,BLK,50-55	1	SNA
..3		BN63-12220A	COVER-STAND REAR;HU7000,ABS,HB	1	SNA
..3		BN68-05603A	LABEL-E,PASS;ALL MODEL,ART,PAPER 90G,60,	1	SNA
..3		BN96-32746A	ASSY ACCESSORY-SCREW;HU7000,6003-001208	1	SNA
...4	SCREW	6003-001208	SCREW-TAPTYP;BH,+,S,M4,L12,ZPC(BLK),SWR	4	SA
...4		6902-000341	BAG PE;LDPE,T0.05,L90,W70,TRP,,,PE MARK	1	SNA
	R001A	BN90-05394Q	ASSY COVER REAR;HU7000	1	SNA
.2	SCREW	6001-002755	SCREW-MACHINE;BH,+,M3,L6,ZPC(BLK),SWRCH1	16	SA
.2	SCREW	6003-001782	SCREW-TAPTYP;BH,+,B,M4,L12,ZPC(BLK),SWR	2	SA
.2	R001A	BN96-33672A	ASSY COVER P-REAR;HU7000,50,HIPS V0,BLK	1	SA
..3		BN60-00162Y	SPACER-FOAM;FOAM,50000mm,DARK GRAY,0.35T	0	SNA
..3	R001	BN63-12213B	COVER-REAR;50HU7000,HIPS,V0,BLK	1	SNA

Level	Loc.	Part Code	Description & Specification	Qty.	SA/SNA
...3	T0071	BN64-02690K	INLAY-TERMINAL;HU7000,PC,T0.3	1	SNA
...3		BN68-05825G	LABEL-TERMINAL SIDE;HU8500,PET,T0.125,W1	1	SNA
1		BN91-12693A	ASSY LCM-INX;BN95-01607A,CY-GH050HG NV1V	1	SNA
.2	PANEL	BN95-01607A	PRODUCT LCD-INX;V500DK2-QS1,CY,GH050HG NV	1	SA
...3	SCREW	6001-003075	SCREW-MACHINE;BH,+,M3,L4,ZPC(WHT),SWRCH1	10	SA
...3	SCREW	6001-003083	SCREW-MACHINE;CH,+,M3,L8,ZPC(BLK),SWRCH1	5	SA
...3		BN02-00114A	TAPE ETC-COF;NNB 55",PET,0.07,T,20,12,GRE	16	SNA
...3		BN02-00152E	TAPE ETC-SHEET FIXING;Y13 SF-LED,PET,0.0	2	SNA
...3	M0131	BN63-00520A	GASKET;APPOLO_PANEL;Conductive Fabric,0.13	4	SNA
...3		BN68-05722A	LABEL-STICKER;AHL-MODEL,POLYPROPYLENE,0.	1	SNA
...3		BN74-00053E	TAPE PAPER-PROTECTION;3M2307,PAPER,0.14T	0	SNA
...3		BN90-05808A	ASSY MISC(BNU);CY-GH050HG NV*	1	SNA
...4		BN61-10113A	SUPPORT-PLATE;Y14 F-LED,PC,V2,WHT/CLEAR,	15	SNA
...4		BN61-10229A	LGP-DIFFUSER PLATE;50inch Diffuser Plat	1	SNA
...4		BN63-12348A	SHEET-REFLECTOR;UXJP175,PET,0.18,1095.26	1	SNA
...4		BN63-12349A	SHEET-PRISM;LTFE34G-10C,PET,0.3,1107.2,62	1	SNA
...4		BN63-12350A	SHEET-DBEF;DLF20,PET,0.25,1108.60,632.00	1	SNA
...4		BN96-32178A	ASSY LED BAR P-LED BAR;U7K 50" INX_L,FC	6	SNA
...4		BN96-32179A	ASSY LED BAR P-LED BAR;U7K 50" INX_R,FC	6	SNA
...4		BN96-32274A	ASSY CHASSIS BOTTOM P;UHD 50" INX,BN64-0	1	SNA
....5		BN02-00040C	TAPE DOUBLE FACE-D-PLATE;F-LED ALL,MKT50	2	SNA
....5		BN02-00173E	TAPE ETC-CORNER;Y13 SNB F8K,PET,0.05,15,	4	SNA
....5		BN02-00352E	TAPE PET-ROLL;Y12 F-LED,PET,T0.05,W30,L5	14	SNA
....5		BN61-10207A	HOLDER-WALL RIVET;Y14 F-LED 52",SWRCH10A	4	SNA
....5		BN61-10569A	HOLDER-MIDDLE U;Y14 F-LED 50" (UHD),PC+G	1	SNA
....5		BN61-10577A	HOLDER-MIDDLE(LR);Y14 F-LED 50" (UHD),PC	2	SNA
....5		BN61-10637A	HOLDER-MIDDLE D;Y14 F-LED 50" (UHD),PC+G	1	SNA
....5		BN62-00602A	INSULATION-PD BOARD UHD;Y14 UHD 48" 50"	1	SNA
....5	T0073	BN63-03871A	GASKET-EMI;58P9,Fabric,2,15,11	4	SNA
....5	CC02	BN64-02652A	CHASSIS-BOTTOM;Y14 F-LED 50" (UHD),EGI-S	1	SNA
....5		BN96-32210A	ASSY BOARD P-LED INTERFACE PD;U7K 50inc	1	SNA
...4		BN96-32283A	ASSY FRAME P-MOLD MIDDLE U;Y14 UHD 50" I	1	SNA
....5		BN61-10563A	FRAME-MOLD MIDDLE U;Y14 F-LED 50" (UHD),	1	SNA
...4		BN96-32284A	ASSY FRAME P-MOLD MIDDLE D;Y14 UHD 50" I	1	SNA
....5		BN60-00744C	SPACER-RUBBER;Y14 SF-LED VNB,SH-0140U+AT	1	SNA
....5		BN60-00815H	SPACER-PANEL (UD);14 SF-LED 50,SHEET+SIL	2	SNA
....5		BN60-01035A	SPACER-MIDDLE;Y14 F-LED UHD 50,PET,L500,	1	SNA
....5		BN60-01036A	SPACER-MIDDLE;Y14 F-LED UHD 50,PET,L550,	1	SNA
....5		BN61-10639A	FRAME-MOLD MIDDLE D;Y14 F-LED 50" (UHD),	1	SNA
...4		BN96-32285A	ASSY FRAME P-MOLD MIDDLE LR;Y14 UHD 50"	2	SNA

Level	Loc.	Part Code	Description & Specification	Qty.	SA/SNA
...5		BN60-00815L	SPACER-PANEL (LR);14 SF-LED 50,SHEET+SIL	2	SNA
...5		BN61-10566A	FRAME-MOLD MIDDLE(LR);Y14 F-LED 50" (UHD	2	SNA
..3	TCON	BN96-30947A	ASSY T CON P;V500DK2-QS1,10bit,50inch,50	1	SA
..3		BN96-30949A	ASSY OPEN CELL;V500DK2-QS1,V500DK2-QS1,1	1	SNA
...4		BN81-09753A	A/S-IC DRIVER SOURCE;INX 50U60,6101B000D	1	SNA
...4		BN81-09754A	A/S-IC DRIVER GATE;INX 50U60,6101B000DK0	1	SNA
...4		BN81-09755A	A/S-A/S-POLARIZER-C/F;INX 50U60,4101B001	1	SNA
...4		BN81-09756A	A/S-A/S-POLARIZER-TFT;INX 50U60,4101B001	1	SNA
...4		BN81-09898A	A/S-A/S-ASSY PCB-SOURCE LEFT;INX 50U60,6	1	SNA
...4		BN81-09899A	A/S-A/S-ASSY PCB-SOURCE RIGHT;INX 50U60,	1	SNA
..3	FL06	BN96-30964B	ASSY CABLE P-FFC;H7000,FFC,NH,48mm1,80	2	SNA
..3	TC01A	BN96-32266A	ASSY CHASSIS TOP P;UHD 50" 7K INX,BN64-0	1	SA
...4		BN60-00715G	SPACER-TOP,CORNER,Y14 Slim UHD,GASKET,L2	3	SNA
...4		BN60-00930J	SPACER-TOP(UD);Y14 VNB 50",GASKET+PET,L1	2	SNA
...4		BN60-00930K	SPACER-TOP(LR);Y14 VNB 50",GASKET+PET,L6	2	SNA
...4		BN63-07229L	SHEET-COVER;rose70",PET+SILICONE,T0.052,	2	SNA
...4	AS080	BN63-10045C	SHEET-COVER,Y13 SF-LED,PC-SHEET,T0.068,W	1	SNA
...4		BN63-12632B	COVER-HOT-STAMPING(FOIL);HU7000,PET,25um	3	SNA
...4		BN64-02130H	BADGE-BRAND;F9K,Ni,0.05,30.0,SILVER,HAIR	1	SNA
...4	AC157	BN64-02655A	CHASSIS-TOP;Y14 F-LED 50" (UHD),PC+ABS+G	1	SNA
..3		BN96-32968A	ASSY COVER P-SOURCE PCB;Y14 UH7K 50",BN6	2	SNA
...4		BN60-00554A	SPACER-SOURCE;SNB 40/46/55,Silicone-Rubb	8	SNA
...4		BN63-12230A	COVER-SOURCE PCB(LR);Y14 F-LED 50" (UHD)	2	SNA
1		BN91-12858A	ASSY SHIELD;UH7R	1	SNA
..2	SCREW	6001-003016	SCREW-MACHINE;PWH,+,M3.0,L5.0,ZPC(WHT),S	19	SA
..2	T0073	AA63-01200A	GASKET-EMI;42S5,Conductive Fabric,0.1mm,	2	SNA
..2		AA63-01335A	GASKET;Twister,Conductive Fabric,0.1mm,2	1	SNA
..2	EC13	BN39-01773L	LEAD CONNECTOR;UE65F8000,Lead Connector,	1	SA
..2	EC13	BN39-01884C	LEAD CONNECTOR;UN28H4200AF,Lead Connecto	1	SA
..2	M-F	BN39-01891G	LEAD CONNECTOR-FUNCTION;HU7000,Lead Conn	1	SA
..2	P001A	BN44-00755A	DC VSS-UHD PD BD;L55N4_ESM,L55N4_ESM,AC/	1	SA
..2	WIFI	BN59-01174A	NETWORK-WIFI MODULE;WIDT-30Q,Internal Wi	1	SA
..2	HOLDER SCREW	BN60-09175B	SCREW-MACHINE;BH,+,M3,L10,ZPC(WHT),SWRCH	2	SA
..2		BN61-10164A	HOLDER-B/T;UH500040",ABS,HB,BT	1	SNA
..2		BN61-10507A	HOLDER-SIDE-A;HU8500,HIPS,1TUNER	1	SNA
..2		BN63-12221A	COVER-IR;HU7000,PC	1	SA
..2	CD01A	BN95-01711A	ASSY DECORATION SMT;HU7000,50,LIGHT TITA	1	SA
..3		BN01-00160A	TARGET-CHROMIUM-CY;Chromium target,99.95	1	SNA
..3		BN01-00161A	TARGET-CHROMIUM-PL;chromium target,over	1	SNA
..3		BN02-00353A	COATING-AFS;SSVD-39,2%,1~10 cps,1.78	2	SNA

Exploded Views and Parts List

Level	Loc.	Part Code	Description & Specification	Qty.	SA/SNA
...3	FD01	BN63-12217A	COVER-DECORATION;HU7000,PC+ABS+G/F15%,50	1	SNA
...3	AS108	BN63-12354D	SHEET-PROTECTION;UH5500,PET,0.04,W10mm,1	1	SNA
...3		BN68-03682A	LABEL-STICKER;Label,20mm,10mm	1	SNA
.2	BT	BN96-30218A	ASSY BOARD P-RF-MODULE;Bluetooth Module,	1	SA
.2	SP01A	BN96-31842E	ASSY SPEAKER P;6ohm,10W,Enclosure_UH7k	1	SA
.2	FL06	BN96-32005X	ASSY CABLE P-FFC;HU7000,FFC(NM),450mm,51P	1	SA
.2	JOG	BN96-32172A	ASSY BOARD P-UHD7K SW FUNCTION;UHD_NT14U	1	SA
.2	IR	BN96-32173A	ASSY BOARD P-UHD7K IR FUNCTION;UHD_NT14U	1	SA
.2	SB05A	BN96-32406A	ASSY BRACKET P-STANDARD LINK;40, 50HU7000,H	1	SNA
...3	M0131	AA63-01296A	GASKET;FIRENZE,Conductive Fabric,12mm,10	2	SNA
...3	CB18	BN61-10596A	BRACKET-STANDARD LINK;HU7000,EGI-SECC,T2.0	1	SNA
.2		GK63-00070A	GASKET;ID45BNKH-10-8-5-23-C,Conductive	3	SNA
1	M0017	BN91-12864B	ASSY CHASSIS;HU7000	1	SNA
.2	M0014	BN94-07582B	ASSY PCB MAIN;HU7000	1	SA
...3		BN62-00365A	HEAT SINK-PS;UN46ESF8000AF,A1050,ANODIZI	1	SNA
...3		BN62-00610A	HEAT SINK-PS;HU9000,A1050,BLACK,100*60*2	1	SNA
...3	AH020	BN62-00625A	HEAT SINK;UN50HU7000FXZA,A1050,BLACK,SJT	1	SNA
...3	T0527	BN68-00313A	LABEL-E,PASS;ALL MODEL,YUPO(110G),BLACK,	1	SNA
...3	T0527	BN68-00395A	LABEL-IC MICOM;MATISSE,GOYA,ART PAPER(10	1	SNA
...3		BN68-03016A	LABEL;LS19MYMKBO/XSJ,JAPAN,FLOURESCENT,1	1	SNA
...3		BN97-08124B	ASSY SMD;UH7S,BN94-07347A	1	SNA
...4		0202-001830	SOLDER-CREAM;LFM-48W TM-HP,D20-38um,96.5	7	SNA
...4	DS01A	0401-001056	DIODE-SWITCHING;MM4BD1148SE,100V,200mA,SO	1	SA
...4		0403-001783	DIODE-ZENER;BZB84-C6V2,5.8/6.6V,300mW,SO	3	SNA
...4		0404-001404	DIODE-SCHOTTKY;BAT721C,40V,200mA,SOT-23,	6	SA
...4		0404-001881	DIODE-SCHOTTKY;SS3040-HE,40V,3000mA,SOD-	1	SA
...4		0406-001200	DIODE-TVS;RCLAMP0504F,6/-V,150W,SC-70	2	SA
...4		0406-001573	DIODE-TVS;AOZ8806DI-05.6	1	SA
...4		0406-001628	DIODE-TVS;AOZ8804ADI,6/-V,150W,SLF2510	1	SA
...4		0406-001635	DIODE-TVS;SMF5.0A,6.4V, 6.7V, 7V,200W,SM	24	SA
...4		0501-000279	TR-SMALL SIGNAL;KSA1182-Y,NPN,150mW,SOT-	2	SA
...4		0501-000445	TR-SMALL SIGNAL;KTC3875SA,Y,NPN,150mW,SOT	2	SC
...4		0504-000126	TR-DIGITAL;KSR1101,NPN,200mW,4.7K/4.7Koh	2	SA
...4		0505-001844	FET-SILICON;SI4435DDY-T1-GE3,P,-30V,-11.	2	SA
...4		0505-002598	FET-SILICON;AP2317GN,P,-20V,-4.2A,0.052o	1	SA
...4		0505-003397	FET-SILICON;2N7002K,N,60V,380mA,1.19ohm,	10	SA
...4		0801-003330	IC-CMOS LOGIC;Octal buffer,DQFN,20P,4.5x	1	SA
...4		0904-002839	IC-USC;GL852G-32,QFN,28P,5x5mm,12MHz,TP,	1	SA
...4		1001-001545	IC-ANALOG MULTIPLEX;TS3USB221ERSER,R-PQF	3	SA
...4		1001-001686	IC-ANALOG MULTIPLEX;74LV4052,CMOS,TTSOP,	1	SA

Level	Loc.	Part Code	Description & Specification	Qty.	SA/SNA
...4		1001-001689	IC-ANALOG SWITCH;TS5A23159RSER,QFN,10P,2	3	SA
...4		1001-001828	IC-ANALOG SWITCH;TS3V330PWR,TSSOP,16P,6.	1	SA
...4		1001-001860	IC-ANALOG SWITCH;NX5L2750CGU,QFN,10P,1.4	1	SNA
...4		1001-001885	IC-VIDEO SWITCH;SII9679,QFN,76P,9x9mm,PL	1	SA
...4		1001-001886	IC-VIDEO SWITCH;QFP,144P,22*22,PLASTIC,T	1	SA
...4		1006-001509	IC-DRIVER/RECEIVER;MAX3222ECPWR,TSSOP,20	1	SA
...4		1103-001564	IC-EEPROM;S-24C512CI-I800,512Kbit,64Kx8	1	SA
...4		1105-002227	IC-DDR3 SDRAM;K4B1G1646G-BCK0,DDR3 SDRAM	2	SA
...4		1105-002529	IC-DDR3 SDRAM;K4B1G1646D-BCK0,DDR3 1600,	4	SA
...4		1201-003690	IC-AUDIO AMP;TAS5747PHPR,QFP,48P,DUAL,PL	1	SA
...4		1203-004363	IC-VOL. DETECTOR;SOT-23,2Z30,2.9x1.6mm,P	1	SA
...4		1203-006109	IC-POS.FIXED REG.;S-1206B33-M3T1G,SOT-2	1	SA
...4		1203-006118	IC-POS.FIXED REG.;S-1172B18-U5T1G,SOT-8	1	SA
...4		1203-006130	IC-POS.FIXED REG.;S-1172B25-U5T1G,SOT-8	1	SA
...4		1203-006330	IC-POWER SUPERVISOR;TPS2065DBV,SOT-23,5P	1	SA
...4		1203-006341	IC-DC/DC CONVERTER;TPS63020,SON-14,14P,4	1	SA
...4		1203-007018	IC-DC/DC CONVERTER;TPS54821RHL,QFN,14P,3	1	SA
...4		1203-007238	IC-PWM CONTROLLER;TPS54427,DDA,3P,4.8x3.	5	SNA
...4		1203-007242	IC-POS.ADJUST REG.;G2992BP1U,SOP-8,8P,	2	SA
...4		1203-007665	IC-DC/DC CONVERTER;RT7266ZSP,SOP-8,8Z30,	3	SNA
...4		1203-007695	IC-DC/DC CONVERTER;AOZ3018,SO-8,8Z30,4.9	1	SNA
...4		1203-007728	IC-VOL. DETECTOR;RT9831GQW,QW : VQFN-20L	1	SA
...4		1203-007755	IC-DC/DC CONVERTER;TPS65253RHD,VQFN,28P,	2	SA
...4		1203-007757	IC-POS.ADJUST REG.;TPS7A7001DDAR,SOIC-8	1	SA
...4		1203-007984	IC-DC/DC CONVERTER;AOZ3015PI,SO-8,8P,6.2	1	SA
...4		1203-008023	IC-POS.ADJUST REG.;AOZ2003PI,SO-8,8P,4.	1	SNA
...4		1203-008104	IC-POS.FIXED REG.;S-13A1D18-E8001,HSOP	2	SNA
...4		1203-008118	IC-DC/DC CONVERTER;AOZ3013PI,SO-8,8P,4.9	2	SNA
...4		1204-003489	IC-VIDEO PROCESS;SDP1301,FCBGA,680P,25x2	1	SA
...4		1204-003514	IC-VIDEO PROCESS;SENK16,HS-PBGA,1135P,35	1	SNA
...4		1204-003530	IC-VIDEO PROCESS;SENK84,HS-PBGA,578P,21	1	SA
...4	IC	1205-004385	IC-ETHERNET CONTROLLER;RTL8201F-VB-CGT,Q	1	SA
...4		1205-004855	IC-SWITCH;TPS25910RSAR,QFN,16P,4x4x0.8mm	1	SA
...4		1205-004983	IC-SWITCH;BD82032FV,TSSOP-B8J,8P,3.0x4.	3	SA
...4		2005-001271	VARIATOR;35V,20Vdc,5A,1.0x0.5x0.6mm,TP,1	20	SA
...4		2007-000057	R-CHIP;40.2Kohm,1%,1/10W,TP,1608	2	SA
...4		2007-000063	R-CHIP;150Kohm,1%,1/10W,TP,1608	1	SNA
...4		2007-000157	R-CHIP;47Kohm,5%,1/16W,TP,1005	16	SNA
...4		2007-000172	R-CHIP;10ohm,5%,1/16W,TP,1005	5	SNA
...4		2007-000173	R-CHIP;22ohm,5%,1/16W,TP,1005	30	SA

Exploded Views and Parts List

Level	Loc.	Part Code	Description & Specification	Qty.	SA/SNA
...4		2007-000512	R-CHIP;2.4Kohm,5%,1/10W,TP,1608	2	SNA
...4		2007-000614	R-CHIP;24Kohm,1%,1/10W,TP,1608	5	SNA
...4		2007-000772	R-CHIP;33Kohm,1%,1/10W,TP,1608	2	SA
...4		2007-000816	R-CHIP;390Kohm,1%,1/10W,TP,1608	3	SA
...4		2007-000828	R-CHIP;39Kohm,1%,1/10W,TP,1608	3	SA
...4		2007-000932	R-CHIP;470ohm,5%,1/16W,TP,1005	10	SA
...4		2007-001116	R-CHIP;680ohm,1%,1/10W,TP,1608	2	SA
...4		2007-001125	R-CHIP;68Kohm,1%,1/10W,TP,1608	2	SA
...4		2007-001168	R-CHIP;75ohm,5%,1/4W,TP,3216	1	SA
...4		2007-001288	R-CHIP;18ohm,5%,1/16W,TP,1005	4	SA
...4		2007-001298	R-CHIP;51ohm,5%,1/16W,TP,1005	1	SA
...4		2007-001320	R-CHIP;1.8Kohm,5%,1/16W,TP,1005	4	SA
...4		2007-002796	R-CHIP;710ohm,5%,1/16W,TP,1005	2	SA
...4		2007-003015	R-CHIP;2.2ohm,5%,1/16W,TP,1005	8	SNA
...4		2007-003022	R-CHIP;62ohm,5%,1/16W,TP,1005	50	SNA
...4		2007-007001	R-CHIP;3.9Kohm,5%,1/16W,TP,1005	2	SA
...4		2007-007095	R-CHIP;390ohm,5%,1/16W,TP,1005	1	SNA
...4		2007-007107	R-CHIP;100Kohm,1%,1/16W,TP,1005	22	SA
...4		2007-007132	R-CHIP;15Kohm,1%,1/16W,TP,1005	2	SA
...4		2007-007133	R-CHIP;300ohm,1%,1/16W,TP,1005	4	SA
...4		2007-007136	R-CHIP;4.7Kohm,1%,1/16W,TP,1005	85	SA
...4		2007-007137	R-CHIP;1.2Kohm,1%,1/16W,TP,1005	3	SA
...4		2007-007138	R-CHIP;27Kohm,1%,1/16W,TP,1005	4	SA
...4		2007-007142	R-CHIP;10Kohm,1%,1/16W,TP,1005	54	SA
...4		2007-007156	R-CHIP;1ohm,5%,1/16W,TP,1005	7	SNA
...4		2007-007306	R-CHIP;100ohm,1%,1/16W,TP,1005	42	SA
...4		2007-007309	R-CHIP;12Kohm,1%,1/16W,TP,1005,0.35	9	SA
...4		2007-007311	R-CHIP;22Kohm,1%,1/16W,TP,1005	10	SA
...4		2007-007312	R-CHIP;20Kohm,1%,1/16W,TP,1005	3	SA
...4		2007-007313	R-CHIP;6.8Kohm,1%,1/16W,TP,1005	3	SA
...4		2007-007314	R-CHIP;5.6Kohm,1%,1/16W,TP,1005	2	SA
...4		2007-007317	R-CHIP;2.2Kohm,1%,1/16W,TP,1005	9	SA
...4		2007-007318	R-CHIP;1Kohm,1%,1/16W,TP,1005	47	SA
...4		2007-007470	R-CHIP;7.5Kohm,1%,1/16W,TP,1005	2	SNA
...4		2007-007517	R-CHIP;240ohm,1%,1/16W,TP,1005	6	SA
...4		2007-007528	R-CHIP;1.5Kohm,1%,1/16W,TP,1005	4	SA
...4		2007-007538	R-CHIP;56Kohm,1%,1/16W,TP,1005	3	SA
...4		2007-007617	R-CHIP;2.49Kohm,1%,1/10W,TP,1608	3	SA
...4		2007-007627	R-CHIP;16Kohm,1%,1/16W,TP,1005	3	SA
...4		2007-007668	R-CHIP;68.1Kohm,1%,1/10W,TP,1608	2	SA

Level	Loc.	Part Code	Description & Specification	Qty.	SA/SNA
...4		2007-007671	R-CHIP;11Kohm,1%,1/16W,TP,1005	4	SA
...4		2007-007698	R-CHIP;5.1Kohm,1%,1/16W,TP,1005	7	SNA
...4		2007-007720	R-CHIP;300Kohm,1%,1/10W,TP,1608	2	SA
...4		2007-007736	R-CHIP;510Kohm,1%,1/10W,TP,1608	1	SA
...4		2007-007766	R-CHIP;2Kohm,1%,1/16W,TP,1005	12	SA
...4		2007-007797	R-CHIP;44.2ohm,1%,1/10W,TP,1608	1	SA
...4		2007-007861	R-CHIP;62Kohm,1%,1/16W,TP,1005	5	SA
...4		2007-007942	R-CHIP;1Mohm,1%,1/16W,TP,1005	5	SA
...4		2007-008015	R-CHIP;75ohm,1%,1/16W,TP,1005	14	SA
...4		2007-008269	R-CHIP;51Kohm,1%,1/16W,TP,1005	4	SA
...4		2007-008275	R-CHIP;30Kohm,1%,1/16W,TP,1005	2	SNA
...4		2007-008294	R-CHIP;3ohm,1%,1/16W,TP,1005	15	SA
...4		2007-008298	R-CHIP;49.9ohm,1%,1/16W,TP,1005	2	SA
...4		2007-008332	R-CHIP;11.5Kohm,1%,1/16W,TP,1005	1	SA
...4		2007-008779	R-CHIP;0ohm,1%,1/16W,TP,1005	93	SA
...4		2007-009117	R-CHIP;49.9Kohm,1%,1/16W,TP,1005	1	SA
...4		2011-001449	R-NETWORK;22ohm,5%,1/16W,L,4P,TP,1010	10	SA
...4		2011-001506	R-NETWORK;10Kohm,5%,1/16W,L,CHIP,4P,TP,1	2	SNA
...4		2011-001527	R-NETWORK;4.7Kohm,5%,1/16W,L,CHIP,4P,TP,	12	SNA
...4		2011-001587	R-NETWORK;100ohm,5%,1/16W,L,CHIP-V,4P,TP	2	SNA
...4	AD480	2203-000233	C-CER,CHIP;0.1nF,5%,50V,C0G,TP,1005	5	SA
...4	AD480	2203-000278	C-CER,CHIP;0.01nF,0.5pF,50V,C0G,TP,1005	6	SA
...4	AD480	2203-000330	C-CER,CHIP;0.012nF,5%,50V,C0G,TP,1005	11	SA
...4	AD480	2203-000359	C-CER,CHIP;0.15nF,5%,50V,C0G,TP,1005,0.5	3	SA
...4	AD480	2203-000386	C-CER,CHIP;0.015nF,5%,50V,C0G,TP,1005	4	SA
...4	AD480	2203-000425	C-CER,CHIP;0.018nF,5%,50V,C0G,TP,1005	4	SA
...4	AD480	2203-000438	C-CER,CHIP;1nF,10%,50V,X7R,TP,1005	36	SA
...4	AD480	2203-000489	C-CER,CHIP;2.2nF,10%,50V,X7R,TP,1005	11	SA
...4	AD480	2203-000585	C-CER,CHIP;0.22nF,10%,50V,X7R,TP,1005	2	SA
...4	AD480	2203-000627	C-CER,CHIP;0.022nF,5%,50V,C0G,TP,1005	3	SNA
...4	AD480	2203-000714	C-CER,CHIP;3.3nF,10%,50V,X7R,TP,1005	3	SA
...4	AD480	2203-000817	C-CER,CHIP;0.033nF,5%,50V,C0G,TP,1005	9	SA
...4	AD480	2203-000940	C-CER,CHIP;0.47nF,10%,50V,X7R,TP,1005	7	SA
...4	AD480	2203-000975	C-CER,CHIP;47nF,10%,25V,X7R,TP,1608	6	SA
...4	AD480	2203-001124	C-CER,CHIP;0.68nF,10%,50V,X7R,TP,1005	1	SNA
...4	AD480	2203-001851	C-CER,CHIP;0.015nF,5%,50V,NP0,TP,1608	2	SNA
...4	AD480	2203-002285	C-CER,CHIP;10nF,10%,50V,X7R,TP,1005	17	SA
...4	AD480	2203-002982	C-CER,CHIP;6.8nF,10%,50V,X7R,TP,1005	5	SA
...4	AD480	2203-003019	C-CER,CHIP;8.2nF,10%,50V,X7R,TP,1005	2	SNA
...4	AD480	2203-003039	C-CER,CHIP;0.008nF,0.25pF,50V,C0G,TP,100	2	SA

Exploded Views and Parts List

Level	Loc.	Part Code	Description & Specification	Qty.	SA/SNA
...4	AD480	2203-005054	C-CER,CHIP;0.0047nF,0.25pF,50V,NP0,TP,10	6	SA
...4	AD480	2203-005083	C-CER,CHIP;220nF,10%,50V,X7R,TP,1608,0.8	8	SA
...4	AD480	2203-005249	C-CER,CHIP;100nF,10%,50V,X7R,TP,1608	32	SA
...4	AD480	2203-005344	C-CER,CHIP;22nF,10%,25V,X7R,TP,1005,0.51	14	SNA
...4	AD480	2203-005968	C-CER,CHIP;4.7nF,10%,50V,X7R,TP,1005,0.5	9	SA
...4	AD480	2203-006047	C-CER,CHIP;33nF,10%,16V,X7R,TP,1005	1	SA
...4	AD480	2203-006126	C-CER,CHIP;47nF,10%,16V,X7R,TP,1005	16	SA
...4	AD480	2203-006158	C-CER,CHIP;100nF,10%,16V,X7R,TP,1005,0.5	414	SA
...4	AD480	2203-006324	C-CER,CHIP;2200nF,10%,10V,X5R,TP,1608	12	SA
...4	AD480	2203-006348	C-CER,CHIP;1000nF,10%,25V,X5R,TP,1608,0.	16	SA
...4	AD480	2203-006562	C-CER,CHIP;1000nF,10%,10V,X5R,TP,1005	40	SA
...4	AD480	2203-006818	C-CER,CHIP;47000nF,20%,6.3V,X5R,TP,3216	2	SA
...4	AD480	2203-006824	C-CER,CHIP;4700nF,10%,10V,X5R,TP,1608	12	SA
...4	AD480	2203-006992	C-CER,CHIP;0.33nF,5%,50V,C0G,TP,1005	1	SNA
...4	AD480	2203-007240	C-CER,CHIP;22000nF,20%,6.3V,X5R,TP,1608,	60	SA
...4	AD480	2203-007269	C-CER,CHIP;22000nF,20%,10V,X5R,TP,2012,0	32	SNA
...4	AD480	2203-007270	C-CER,CHIP;10000nF,10%,10V,X5R,TP,1608,0	173	SNA
...4	AD480	2203-007306	C-CER,CHIP;10000nF,10%,25V,X5R,TP,2012,1	10	SA
...4		2402-001268	C-AL,SMD;100uF,20%,25V,WT,TP,8x6.3mm	2	SA
...4		2409-001118	C-POLYMER,CHIP;47uF,20%,10V,WT,TP,3.5X2	2	SA
...4		2409-001191	C-ORGANIC,SMD;47uF,20%,20V,TP,7343(1.9T)	1	SA
...4		2703-000158	INDUCTOR-SMD;1uH,10%,2012,40ohm,50mA,45,	3	SA
...4		2703-001229	INDUCTOR-SMD;2.2uH,10%,1608,1.15Ohm,15mA	1	SC
...4		2703-001938	INDUCTOR-SMD;56nH,5%,1005,1.50ohm,200mA,1	2	SA
...4		2703-002834	INDUCTOR-SMD;1.8uH,20%,10x10mm,.005ohm,1	1	SA
...4		2703-003135	INDUCTOR-SMD;4.7uH,20%,6965,0.040hm,7000	5	SNA
...4		2703-003149	INDUCTOR-SMD;2.2uH,20%,5050,0.0550hm,300	2	SA
...4		2703-003263	INDUCTOR-SMD;3.3uH,20%,10.0x10.0mm,0.00	4	SNA
...4		2703-003713	INDUCTOR-SMD;1.5uH,20%,7366,0.015ohm,700	4	SA
...4		2703-003824	INDUCTOR-SMD;3.3uH,20%,7070	1	SA
...4		2703-003937	INDUCTOR-SMD;1uH,20%,7.0x6.47x3.0mm,0.00	1	SA
...4		2703-004724	INDUCTOR-SMD;8.2uH,20%,5050,4mm,0.072Ohm	4	SA
...4		2801-000102	CRYSTAL-SMD;12MHz,30ppm,12pF,100ohm,TP	3	SA
...4		2801-004814	CRYSTAL-SMD;25MHz,50ppm,8pF,100ohm,TP	2	SA
...4		2801-005291	CRYSTAL-SMD;12MHz,30ppm,4 PIN,16pF,100Oh	1	SNA
...4		2801-005324	CRYSTAL-SMD;27MHz,30ppm,Ceramic SMD(4pin	1	SA
...4		2801-005373	CRYSTAL-SMD;156.25MHz,50ppm,TP	1	SA
...4		3301-002039	BEAD-SMD;26ohm,1608,TP	118	SA
...4		3601-001374	FUSE-SURFACE MOUNT;32V,5A,FAST-ACTING,PL	3	SA
...4		3701-001856	CONNECTOR-HDMI;19P,2ROW,FEMALE,SMD-S,AU	1	SA

Level	Loc.	Part Code	Description & Specification	Qty.	SA/SNA
...4		3701-001861	CONNECTOR-HDMI;19P,2ROW,FEMALE,SMD-A,AU	3	SA
...4		3707-001104	CONNECTOR-OPTICAL;SMD-A(Ultra Slim),SPDI	1	SA
...4		3708-003073	CONNECTOR-FPC/FFC/PIC;51P,0.5mm,SMD,AU,N	1	SA
...4		3710-003901	SOCKET-INTERFACE;34P,2R,0.5mm,SMD-A,AU,B	1	SA
...4	EH01	3711-008131	HEADER-BOARD TO CABLE;BOX,4P,1R,2.5mm,AN	1	SA
...4	EH01	3711-008441	HEADER-BOARD TO CABLE;BOX,24P,2R,2mm,ANG	1	SA
...4	EH01	3711-008558	HEADER-BOARD TO CABLE;BOX,26P,2R,1.25mm,	1	SA
...4		3722-003226	JACK-PHONE;7P/1C,SN,BLK	1	SA
...4		3722-003229	JACK-MODULAR;8P/8C W/L,Y,STRAIGHT,N,Au,1	1	SA
...4		3722-003457	JACK-USB;4P/1C,NI,BLK,A	2	SA
...4	JACK PIN	3722-003546	JACK-PIN;5P,Screw hole,NI+SN,G,1/BLU/RED	1	SA
...4		3722-003617	JACK-PHONE;14P/2C,SN,BLK,STRAIGHT;3,6PI,	1	SA
...4		3722-003725	JACK-PIN;3P,NI+SN,YEL/WHT/RED,STRAIGHT	1	SA
...4		3722-003837	JACK-USB;9P/1C,AU/SN/NI,BLU,SMD-A,A,3,0,	1	SA
...4		6302-001290	GASKET;SMP-TS-4-4.5-3,4.0mm,Ni+Au+SUS+Mg	9	SNA
...4	ET01	BN40-002841A	TUNER;DTOS40EIH276B,DTOS40EIH276B,DVB-TC	1	SA
...4		BN41-03206B	PCB MAIN;JHD_NT14U,FR-4,4,1.6T,235x280	1	SNA
...4		BN68-01078A	LABEL-IC MICOM;7mm,7mm,WHITE	1	SNA
...4		BN68-03016A	LABEL;LS19MYMKBQ/XSJ,JAPAN,FLOURESCENT,1	1	SNA
...4		BN68-05360A	LABEL-MICOM IC;Art Paper(100G),4mm,4mm,P	1	SNA
...4		BN68-06368A	LABEL-MICOM IC;ART 100G,4mm,4mm,Silver	1	SNA
...4		BN68-06551A	LABEL-MICOM IC;ART 100G,4mm,4mm,Red	1	SNA
...4		BN97-08586A	ASSY MICOM-MAIN;T-NT14UUABC-XXXX,U8JA,KL	1	SNA
....5		1107-002287	IC-EMMC;KLM4G1FEAC-C031,4GPyte,BGA,153P,	1	SA
...4		BN97-08597A	ASSY MICOM-HDMI;W25Q16DVSSIG,U8JA,W25Q40	1	SNA
...4		BN97-08598A	ASSY MICOM-SUB;T-NT14UDEUS-XXXX,U8JA,W25	1	SNA
....5		1107-002226	IC-NOR FLASH;W25Q40CLSSIP,4Mbit,SOIC,8P,	1	SNA
...4		BN97-08599A	ASSY MICOM-FRC;NT72323_SPI,U8JA,W25Q16DV	1	SNA
....5		1107-002223	IC-NOR FLASH;W25Q16DVSSIG,16Mbit,2Mbitx8	1	SNA
...4		BN97-08693A	ASSY MICOM-SPI;U8JA,W25Q148BVSSIG,1107-00	1	SNA
....5		1107-002210	IC-NOR FLASH;W25Q128FVSSIG,128Mbit,128Mx1	1	SA
...4		BN97-08871A	ASSY MICOM-BLASTER(IR,BLASTER MICOM,UH7R	1	SNA
....5		BN13-00067A	PLD;MAXQ636V-2591-T,WLP,9	1	SNA
...5		BN97-08600A	ASSY DRM-KEY;NT14,HU7*US	1	SNA
...4		BN46-00109H	KEY CODE-CERTIFI;MAC,TV/AV,General	1	SNA
...4		BN46-00110N	KEY CODE-CERTIFI;MIRACAST,TV,X12 /X13	1	SNA
1		BN92-14141A	ASSY P/MATERIAL;HC7000	1	SNA
.2		0203-001598	TAPE-FILAMENT;#8915,0.15,12,55000,CLR	0	SNA
.2		6902-000604	BAG WRAPPING;LDPE,T0.02,W500,L10000,TRP,	5	SNA
.2		6902-000609	BAG ROLL;LDPE,T0.05,W2400,L1000,TRP,30.0	0	SNA

Exploded Views and Parts List

Level	Loc.	Part Code	Description & Specification	Qty.	SA/SNA
.2		BN02-00308A	TAPE OPP-MASKING;OPP,T0.05,W60,L800m,CLE	3	SNA
.2		BN63-07473A	SHEET-ROLL;HDPE/NITRON,0.5,W1050,L500m,W	1	SNA
.2		BN63-08908A	SHEET-PE/ROLL;PS43D450A2MXXY,HDPE+PE FOA	1	SNA
.2		BN69-00391Q	PAD-ANGLE;PAPER,T5,50,1800,YEL	1	SNA
.2		BN69-09404A	PAD-EPE;Y13 50" ALL,EPE,T10,150,150,20g/	2	SNA
.2		BN69-09784A	CUSHION-FRONT;UH5000-50,EPS	1	SNA
.2		BN69-10166A	CUSHION-SET;50HU7000,EPS,50inch	1	SNA
1		BN92-14163E	ASSY BOX;HU7000	1	SNA
.2		BH68-00662A	LABEL BOX-01;ALL MODEL,ART PAPER,60,110,	1	SNA
.2		BN69-10287Q	BOX-SET;50UH7000,TS,CB,A-01,DW3,YEL,W125	1	SNA
1		BN92-15091T	ASSY LABEL;HU7000	1	SNA
.2		BN02-00102B	TAPE FILAMENT;UE7000,#8917,ø 15,25,50,WH	0	SNA
.2		BN68-04577A	LABEL-SERVICE STICKER;TV,XY,Art Paper T0	1	SNA
.2		BN68-05050A	LABEL RATING;ALL,SS,PE,T0.05,93,73,Dark	1	SNA
.2		BN68-05799T	LABEL-ENERGY;UH7R,XY,PET,T0.1,70,116,Ene	1	SNA
.2		BN68-05952F	LEAFLET-QSG;HU7000,India,ASIA,ART PAPER	1	SNA
.2		BN68-06127A	LABEL-01,HIGHLIGHT POP;U8000/7000 Series	1	SNA
1	ACCE1	BN92-15133Y	ASSY ACCESSORY;HU7000	1	SNA
.2		BN96-31666Z	ASSY ACCESSORY MANUAL/CABLE;HC7000	1	SNA
..3	T0268	3903-000845	CBT-POWER CORD;DT,SAA,LP-15AL,250V,2.5A,	1	SA
..3		4801-000101	BATTERY-ALKALINE;1.5V,1650mAh,LR6,14.5x5	2	SNA
..3		6902-001962	BAG PE;LDPE,BIOBASED,T0.05,W400,L300 TRP	1	SNA
..3	REMO3	BN59-01185B	REMOCON-14SMART TOUCH CONTROL;TM1460_MUL	1	SA
..3		BN68-02298C	LABEL-STICKER;TV,XY,ART PAPER,T0.05,93,4	1	SNA
..3		BN68-04972A	MANUAL FLYER-06 REGULATORY GUI;ALL,SAMSU	1	SNA
..3		BN68-05497A	LABEL;Art Paper(100G),23mm,60mm,Blue,Whi	1	SNA
..3		BN68-05971A	LEAFLET-01,WARRANTY CARD;comm,Samsung,EN	1	SNA
..3		BN68-06160A	MANUAL USERS;UHD7000,ENG,XY,W/P,B5	1	SNA
..3	CAIR	BN96-31644A	ASSY CABLE P;IR BLASTER,UL1185 28AWG,2.5	1	SA