

1. Exploded View & Part List

Exploded View

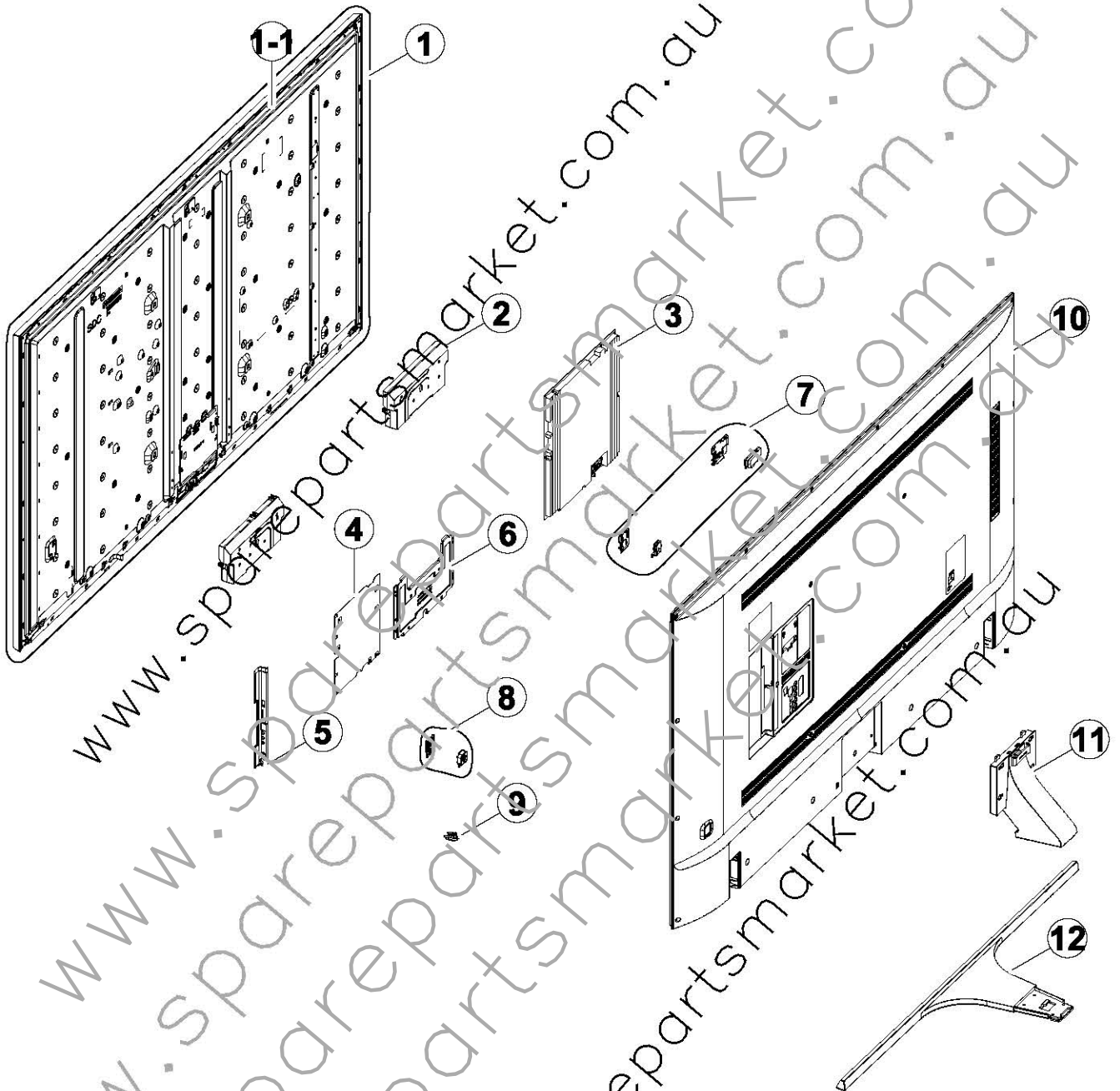

Parts List

No.	Lvl.	Loc.	Material Code	Description & Specification	SNA	Qty.
1	2	PANEL	BN95-01977A	PRODUCT LCD-SDC; CY-GJ075FLLV1V,JU7000,Ba	SA	1
1-1	3	TC01A	BN96-35028A	ASSY CHASSIS TOP P-Y75 FLAT JU7000,75,BN	SA	1
2	2	SP01A	BN96-35006D	ASSY SPEAKER P; 6ohm,4pin,10W,JU6400 65"	SA	1
3	2	P001A	BN44-00813A	DC VSS-LED TV PD BD; L78S7N_FSM,L78S7N_FS	SA	1
4	2	M0014	BN94-08409H	ASSY PCB MAIN; JU7000	SA	1
5	2		BN61-11928A	HOLDER SIDE AV; JU7500,HIPS,LATIN,1 TUNNE	SNA	1
6	3	CB18	BN61-11518B	BRACKET-STAND LINK; JU7000 75",EGI-SECC A	SNA	1
7	2	NW01	BN59-01194F	NETWORK; Mac Combo,Internal WiFi,USB 2.0	SA	
8	2		BN96-35345B	ASSY BOARD P-FUNCTION_SW; JU7500,Function	SA	1
9	2	FB01A	BN96-35346B	ASSY BOARD P-FUNCTION ASSY; JU7500,Function	SA	1
10	2	R001A	BN96-35243L	ASSY COVER P-REAR; JU7000 75",AUSTRALIA,P	SA	1
11	2		BN96-35527B	ASSY GUIDE P-STAND NECK; JU7000 75",ABS B	SA	1
12	2	SB04A	BN96-35545C	ASSY STAND P-BASE; JU7K 75,ABS, HAIRLINE,	SA	1

2. Electrical Parts List

Level	Loc.	Part Code	Description & Specification	Qty.	SA/SNA
			UA75JU7000WXXY (TS01)		
1		BN90-06678J	ASSY W/I;JU7K	1	SNA
.2		BN81-08159Z	PART SET-ELEC W/I;UF**,UH**,UG**,ELEC	1	SNA
.2		BN81-11246G	A/S PART SET-MECH W/I;UJ7U, U75JU*	1	SNA
1	R001A	BN90-07147H	ASSY COVER REAR;JS7K 75	1	SNA
.2	SCREW	6001-002755	SCREW-MACHINE;BH,+ ,M3,L6,ZPC(BLK),SWRCH1	22	SA
.2	SCREW	6003-000003	SCREW-TAPTTYPE;BH,+ ,B,M4,L10,ZPC(BLK),S	1	SA
.2	R001A	BN96-37243L	ASSY COVER P-REAR;JU7000 75",AUSTRALIA,P	1	SA
.3	R001	BN63-14468A	COVER-REAR;JU7000 75",PC+ABS+GF15%,BLK,V	1	SNA
.3		BN68-06889D	LABEL-TERMINAL SIDE;JU7500,PET,T0.125,15	1	SNA
1	S001A	BN90-07176C	ASSY STAND;JS7K 75"	1	SNA
.2		BN96-35527B	ASSY GUIDE P-STAND-NECK;JU7000 75",ABS B	1	SA
.3	SCREW	6003-001086	SCREW-TAPTTYPE;BH,+ ,B,M3,L12,ZPC(BLK),S	1	SA
.3		6902-002472	BAG PE;HDPE/PE FOAM,T0.015/T0.5,W300,L75	1	SNA
.3		BN61-11645A	BRACKET-STAND NECK;JU7000_75,ALDC,AL DIE	1	SNA
.3	AH089	BN61-11888A	HOLDER-CABLE;JU7500,ABS,BLK	1	SNA
.3	CCM1	BN62-05135D	SHEET-COVER;Ruby 32",PE,T 0.5,80mm	0	SNA
.3		BN63-13252A	COVER-NECK;JU7000 75",ABS,BLK	1	SNA
.3		BN63-13327A	COVER-NECK SUB;JU7000 75",ABS,BLK	1	SNA
.3		BN96-36261A	ASSY ACCESSORY-SCREW;JU7000 75",6003-001	1	SNA
.4	SCREW	6003-001324	SCREW-TAPTTYPE;BH,+ ,S,M4,L14,ZPC(BLK),SWR	4	SNA
.4		6902-002476	BAG SCREW;LDPE,T0.05*,W70,L90,TRP,RECYCL	1	SNA
.3		BN96-36262A	ASSY ACCESSORY-SCREW;JU7000 75",6001-000	1	SNA
.4		6001-000706	SCREW-MACHINE;PH,+ ,M4,L16,ZPC(WHT),SWR	4	SNA
.4		6902-002477	BAG SCREW;LDPE,T0.05*,W70,L90,TRP,RECYCL	1	SNA
.2	SB04A	BN96-35545C	ASSY STAND P-BASE;JU7K 75,ABS, HAIRLINE,	1	SA
.3	SCREW	6003-001001	SCREW-TAPTTYPE;FH,+ ,B,M3,L8,ZPC(BLK),SW	2	SA
.3	SCREW	6003-001321	SCREW-TAPTTYPE;BH,+ ,B,M4,L8,ZPC(BLK),SWRC	4	SA
.3	SCREW	6003-001374	SCREW-TAPTTYPE;FH,+ ,B,M4,L12,MI PLT,SWRCH	2	SA
.3		6902-002437	BAG PE;HDPE/PE FOAM,T0.015/T0.5,W1100,L1	1	SNA
.3		6902-002509	BAG PE;HDPE/PE FOAM,T0.015/T0.5,W300,L55	1	SNA
.3		BN60-00162A	SPACER-FOAM;FOAM,50000L,BLK,0.35T,20W	1	SNA
.3		BN61-04692A	BOSS-PRIMER;#94,SHEET,clear,35cps	0	SNA
.3		BN61-11525A	BRACKET-STAND BAR;JU7000_75,HGI,T1.8	1	SNA
.3		BN63-13287A	COVER-STAND TOP;JU7000 75",ABS,BLK	1	SNA
.3		BN67-00327J	RUBBER-FOOT;RUBBER-FOOT,SILICONE,SQUARE,	7	SNA
.3		BN68-05603A	LABEL-E,PASS;ALL MODEL,ART PAPER 90G,60,	1	SNA
.3		BN95-02084B	ASSY COVER STAND SMT-FRONT;JU7K 75,LIGHT	1	SNA

Exploded Views and Parts List

Level	Loc.	Part Code	Description & Specification	Qty.	SA/SNA
...4		0204-006861	COATING;SMT-L100,CLEAR,0.928	0	SNA
...4		BN01-00160A	TARGET-CHROMIUM-CY;Chromium target,99.95	1	SNA
...4		BN01-00161A	TARGET-CHROMIUM-PL;chromium target,over	1	SNA
...4		BN63-13248B	COVER-STAND FRONT;JU7000 75",AB8+PC,LIGH	1	SNA
...4		BN63-14064D	SHEET-COVER;PE+PP,0.068,W40,CLEAR,100g/i	1	SNA
...3		BN96-35523A	ASSY BRACKET P-BASE;JU7500,78	1	SNA
...4	SCREW	6003-001374	SCREW-TAPTYPE;FH,+,B,M4,L12,NI PLT,SWRCH	2	SA
...4		BN61-11499A	BRACKET-STAND BASE;JU7000_75,PO-SPHC,T5	1	SNA
...4		BN61-11528A	BRACKET-BASE LINK;JU7000 75",PO-SPHC,T5	1	SNA
1		BN91-13752A	ASSY LCM-SDC;BN95-01977A,CY-GJ075FLLV1V	1	SNA
2	PANEL	BN95-01977A	PRODUCT LCD-SDC;CY-GJ075FLLV1v,JU7000,Ba	1	SA
...3	SCREW	6001-003075	SCREW-MACHINE;BH,+,M3,L4,ZPC(WHT),SWRCH1	10	SA
...3	SCREW	6001-003079	SCREW-MACHINE;CH,+,M3,L6,ZPC(BLK),SWRCH1	8	SA
...3		BN68-05722A	LABEL-STICKER;ALI_MODEL,POLYPROPYLENE,0.	1	SNA
...3		BN90-06311A	ASSY MISC-BLU;CY-GJ075FLLV1V	1	SNA
...4		BN02-00102B	TAPE-FILAMENT;#8917,0.15,25,30,WHITE	0	SNA
...4		BN61-11754A	LGP-DIFFUSER-PLATE;75inch Flat, Diffuse	1	SNA
...4		BN63-13311A	SHEET-DBEF;DBEF D2 400,PC,0.4,1661.8,941	1	SNA
...4		BN63-13314A	SHEET-PRISM;UTE34G-13LP,PET,0.425,1661.8	1	SNA
...4		BN63-13520A	SHEET-REFLECTOR;SY95S,PET,0.188,823.06,9	1	SNA
...4		BN96-34763A	ASSY LED BAR P-LED BAR;75" UHD_L_SDC,6ea	9	SNA
...4		BN96-34764A	ASSY LED BAR P-LED BAR;75" UHD_M_SDC,6ea	9	SNA
...4		BN96-34765A	ASSY LED BAR P-LED BAR;75" UHD_R_SDC,6ea	9	SNA
...4		BN96-35035A	ASSY FRAME P-MOLD MIDDLE LR;Y15 FLAT, 75	2	SNA
....5		BN60-00735Y	SPACER-MIDDLE;Y14 VNB 65,PET,L910,NTR,T0	2	SNA
....5		BN60-01120K	SPACER-PANEL(LR);Y15 UHD Flat 75" SDC,SI	2	SNA
....5		BN61-11412A	FRAME-MOLD MIDDLE LR;Y15 JU7K 75",PC+GF1	2	SNA
...4		BN96-35042A	ASSY FRAME P-MOLD MIDDLE D;Y15 FLAT,75,	1	SNA
....5		BN61-11411A	FRAME-MOLD MIDDLE D;Y15 JU7K 75",PC+GF10	1	SNA
...4		BN96-35049A	ASSY FRAME P-MOLD MIDDLE U;Y15 FLAT, 75,	1	SNA
....5		BN60-00744A	SPACER-RUBBER;Y13 F-LED SLIM,SP-0140U+AT	1	SNA
....5		BN60-01023J	SPACER-MIDDLE UD;Y15 JU7K 75",PET,L825,N	2	SNA
....5		BN60-01120J	SPACER-PANEL(UD);Y15 UHD Flat 75" SDC,SI	2	SNA
....5		BN61-11410A	FRAME-MOLD MIDDLE U;Y15 JU7K 75",PC+GF10	1	SNA
...4		BN96-35060A	ASSY CHASSIS BOTTOM P;Y15 FLAT, 75,BN64-	1	SNA
....5		0203-006897	TAPE-DOUBLE FACE;SI,T1.0,W10,L50,WHT	2	SNA
....5	SCREW	6001-003075	SCREW-MACHINE;BH,+,M3,L4,ZPC(WHT),SWRCH1	2	SA
....5		BN02-00040C	TAPE DOUBLE FACE-D-PLATE;F-LED ALL,MKT50	6	SNA
....5		BN02-00173C	TAPE OPP;PET,0.05,40,BLK	0	SNA
....5		BN02-00352E	TAPE OPP;PET,T0.05,W15,L50M,BLK,ULNO.E16	0	SNA

Level	Loc.	Part Code	Description & Specification	Qty.	SA/SNA
....5		BN61-11413A	HOLDER-MIDDLE U;Y15 JU7K 75",PC+GF10%,LI	1	SNA
....5		BN61-11414A	HOLDER-MIDDLE D;Y15 JU7K 75",PC+GF10%,LI	1	SNA
....5		BN61-11415A	HOLDER-MIDDLE LR;Y15 JU7K 75",PC+GF10%,L	2	SNA
....5		BN61-11477A	HOLDER-SOURCE PCB;Y15 JU7K SDC,ABS,BLK,H	8	SNA
....5		BN61-11508A	SUPPORT-PLATE;Y15 LED,PC,V2 CLEAR,OD-19m	30	SNA
....5		BN62-00690D	INSULATION-PD-BOARD;JU7500,PC,0.45,340.0	1	SNA
....5		BN63-14371A	GASKET;CTGF10-07-025-08,Conductive Fabri	4	SNA
....5		BN63-14372A	GASKET;CTGF10-07-035-08,Conductive Fabri	1	SNA
....5	CC02	BN64-02868A	CHASSIS-BOTTOM;Y15 JU7K 75",EGI-SECC AG,	1	SNA
....5		BN67-00338E	RUBBER-BOTTOM;Y15 ALL MODEL SILICON,T3.0	2	SNA
....5		BN96-34721A	ASSY BOARD P-LED INTERFACE BOARD;16pin 7	1	SNA
....5		BN96-34722A	ASSY BOARD P-LED INTERFACE BOARD;16pin 7	1	SNA
...4		BN97-09469A	ASSY SHEET-REFLECTOR;3Y95S,833.06 X 926.	1	SNA
..3	FL06	BN96-34971A	ASSY CABLE P-FEC;UHD,FFC,NH,57mm 1.0,68	4	SNA
..3		BN96-35021A	ASSY COVER P-SOURCE PCB;Y15 FLAT, 75,BN6	1	SNA
...4		BN62-00537V	INSULATION-S-COVER-L;Y15 JU7K 75",PET,	1	SNA
...4		BN63-13208A	COVER-SOURCE PCB L;Y15 JU7K 75",EGI-SECC	1	SNA
..3	TC01A	BN96-35028A	ASSY CHASSIS TOP P;Y15 FLAT JU7000,75,BN	1	SA
...4		0203-001598	TAPE-FILAMENT;#8915,0.15,12,55000,CLR	0	SNA
...4		BN02-00381L	TAPE CONDUCTIVE-PTC(UD);Y15 UHD Flat 75"	2	SNA
...4		BN02-00381M	TAPE CONDUCTIVE-PTC(UR);Y15 UHD Flat 75"	2	SNA
...4		BN60-00715A	SPACER TOP;CORNER;Y13 Slim F-LED,GASKET*	2	SNA
...4		BN60-01115A	SPACER-TOP LINK;Y15 JU7K,CONDUCTIVE FABR	5	SNA
...4		BN63-07229E	SHEET-COVER;UC6620/6630 46",TOC,T0.052,W	6	SNA
...4	AC157	BN64-02867A	CHASSIS-TOP;Y15 JU7K 75" PC+ABS+MF15%,BL	1	SNA
....5		BN01-00266A	FILM HOT STAMPING;PET,25um,30mm,600m,Dar	4	SNA
...4	FD01A	BN96-35426A	ASSY DECORATION P;JU7000 75,PC+ABS MF17%	1	SNA
....5		BN63-07229E	SHEET-COVER;UC6620/6630 46",TOC,T0.053,W	2	SNA
....5	FD01	BN63-13227A	COVER-DECORATION;JU7000 75",PC+ABS+MF17%	1	SNA
....6		BN01-00260A	FILM HOT STAMPING;PET,23um,30mm,600m,Dar	2	SNA
....6		BN64-03024A	BADGE-BRAND;JU7500,Ni,0.08,4.52,32,SILVE	1	SNA
..3		BN96-35063A	ASSY OPEN CELL;LSF750F01-K,8bit,75INCH,	1	SNA
...4		BN81-07435A	A/S-ADHESIVE-A.C.F;ADHESIVE-A.C.F,2-ADHE	1	SNA
...4		BN81-07943A	A/S-ADHESIVE-A.C.F(TP500B);ADHESIVE-A.C.	1	SNA
...4		BN81-10628A	A/S-POLARIZER-C/F;POLARIZER-C/F,LJ01-098	1	SNA
...4		BN81-10629A	A/S-POLARIZER-TFT;POLARIZER-TFT,LJ01-098	1	SNA
...4		BN82-01558A	A/S ASSY-ASSY PCB-SOURCE(F-L);ASSY PCB-S	1	SNA
...4		BN82-01559A	A/S ASSY-ASSY PCB-SOURCE(F-R);ASSY PCB-S	1	SNA
...4		BN82-01560A	A/S ASSY-ASSY PCB-SOURCE(B-L);ASSY PCB-S	1	SNA
...4		BN82-01561A	A/S ASSY-ASSY PCB-SOURCE(B-R);ASSY PCB-S	1	SNA

Exploded Views and Parts List

Level	Loc.	Part Code	Description & Specification	Qty.	SA/SNA
...4		BN82-01562A	A/S ASSY-IC DRIVER GATE;IC DRIVER GATE,L	1	SNA
...4		BN82-01563A	A/S ASSY-IC DRIVER SOURCE;IC DRIVER SOUR	1	SNA
...3	TCON	BN96-35079A	ASSY T CON P;LMF750FJ01-K,PCB-CONTROL,8b	1	SA
...3		BN96-35637A	ASSY COVER P-SOURCE R;Y15 JU7000 75",EGI	1	SNA
...4		BN62-00537U	INSULATION-S-COVER-R;Y15 JU7K 75",PET,0.	1	SNA
...4		BN63-13209A	COVER-SOURCE PCB R;Y15 JU7K 75",EGI-SECC	1	SNA
1	M0017	BN91-14350H	ASSY CHASSIS;JU7000	1	SNA
.2	M0014	BN94-08409H	ASSY PCB MAIN;JU7000	1	SA
...3	AH020	BN62-00723A	HEAT SINK;Y15 UHD 7K/7.5K,A1050,BLACK	1	SNA
...3		BN97-09415M	ASSY SMD;JU7K	1	SNA
...4	DS01A	0401-001056	DIODE-SWITCHING;MMBD41488E,100V,200mA,SO	1	SA
...4		0404-001404	DIODE-SCHOTTKY;BAT721C,40V,200mA,SOT-23,	1	SA
...4		0406-001200	DIODE-TVS;RCLAMP0504F,6/-V,150W,SC-70	1	SA
...4		0406-001573	DIODE-TVS;AOZ8806DI-05,6	1	SA
...4		0406-001628	DIODE-TVS;AOZ8804ADI,6/-V,150W,SLP2510	1	SA
...4		0406-001635	DIODE-TVS;SMF5.0A,6.4V, 6.7V, 7V,200W,SM	4	SA
...4		0501-000445	TR-SMALL SIGNAL;KTC3875S-Y,NPN,150mW,SOT	4	SC
...4		0504-000120	TR-DIGITAL;KSR1101,NPN,200mW,4.7K/4.7koh	1	SA
...4		0505-001844	FET-SILICON;SI4435DDY-T1-GE3,P,-30V,-11.	1	SA
...4		0505-002598	FET-SILICON;AP2317GN,P,-20V,-4.2A,0.052o	1	SA
...4		0505-002854	FET-SILICON;AO5404E,N,20V,0.5A,0.55ohm,0	1	SNA
...4		0505-002893	FET-SILICON;AO4801AS,P,-30V,-5A,2W,SOIC-	1	SA
...4		0505-003397	FET-SILICON;2N7002K,N,60V,380mA,1.19ohm,	1	SA
...4		0801-002780	IC-CMOS LOGIC;74LVCI17,SCHMITT-TRIGGER	1	SA
...4		1001-001860	IC-ANALOG SWITCH;NX5L2750CGU,QFN,10P,1.4	1	SNA
...4		1001-001934	IC-VIDEO SWITCH;SI19777,LQFP,208P,28X28m	1	SNA
...4		1103-001564	IC-EEPROM;S-24C512CI-L800,512Kbit,64Kx8,	1	SA
...4		1105-002528	IC-DDR3 SDRAM;K4B4G1646D-BCMA,DDR3,1866,	4	SA
...4		1105-002534	IC-DDR3 SDRAM;K4B2G1646Q-BCMA,DDR3 SDRAM	2	SA
...4		1201-000166	IC-OP AMP;LM358,SOP,ST,8P,150MIL,DUAL,10	1	SA
...4		1201-003891	IC-AUDIO AMP;NTP7415,MLF,48P,7x7mm,DUAL,	1	SA
...4		1203-004384	IC-VOL. DETECTOR;RT9818C-42PV,SOT-23,3P,	1	SA
...4		1203-006330	IC-POWER SUPERVISOR;TPS2065DBV,SOT-23,5P	1	SA
...4		1203-007018	IC-DC/DC CONVERTER;TPS54821RHL,QFN,14P,3	1	SA
...4		1203-007238	IC-PWM CONTROLLER;TPS54427,DDA,8P,4.8x3.	2	SNA
...4		1203-008022	IC-POS.ADJUST REG.;AOZ2003PI,SO-8,8P,4.	2	SA
...4		1203-008082	IC-DC/DC CONVERTER;TPS54627DDAR,SOP 8P,8	1	SA
...4		1203-008104	IC-POS.FIXED REG.;S-13A1D18-E8001,HSOP,	2	SNA
...4		1203-008183	IC-DC/DC CONVERTER;AOZ3015PI-1,EPAD SO-8	2	SA
...4		1203-008392	IC-VOL. DETECTOR;S-6414AAB-L800X,TSOT-23	1	SA

Level	Loc.	Part Code	Description & Specification	Qty.	SA/SNA
...4		1203-008393	IC-DDR TERMINATION REG.;AP2303MTR-G1-89,	1	SA
...4		1203-008405	IC-DC/DC CONVERTER;AOZ3103DI,DFN3X3,8P,3	1	SA
...4		1203-008454	IC-DC/DC CONVERTER;TPS56528,HSOP8,8P,4,8	1	SA
...4		1204-003587	IC-DECODER;SDP1406,PBGA,1053P,14x31mm,PL	1	SA
...4		1205-004610	IC-SWITCH;TPS2421-2DDA,SO-8,8Z30,5X6X1.7	1	SA
...4		1205-004983	IC-SWITCH;BD82032FVJ,TSSOP-B8J,8P,3.0x4.	1	SA
...4		1405-001271	VARISTOR;35V,20Vdc,5A,1.9x0.5x0.6mm,TP,	13	SA
...4		2007-000141	R-CHIP;2.2Kohm,5%,1/16W,TP,1005	1	SNA
...4		2007-000145	R-CHIP;6.2Kohm,5%,1/16W,TP,1005	1	SA
...4		2007-000148	R-CHIP;10Kohm,5%,1/16W,TP,1005	3	SA
...4		2007-000157	R-CHIP;47Kohm,5%,1/16W,TP,1005	2	SNA
...4		2007-000162	R-CHIP;100Kohm,5%,1/16W,TP,1005	1	SNA
...4		2007-000170	R-CHIP;1Mohm,5%,1/16W,TP,1005	1	SA
...4		2007-000172	R-CHIP;10ohm,5%,1/16W,TP,1005	1	SNA
...4		2007-000173	R-CHIP;22ohm,5%,1/16W,TP,1005	14	SA
...4		2007-000174	R-CHIP;47ohm,5%,1/16W,TP,1005	50	SA
...4		2007-000683	R-CHIP;22Kohm,1%,1/10W,TP,1608	2	SA
...4		2007-000683	R-CHIP;3.3Kohm,1%,1/10W,TP,1608	1	SA
...4		2007-000695	R-CHIP;3.3ohm,5%,1/10W,TP,1608	4	SNA
...4		2007-000772	R-CHIP;33Kohm,1%,1/10W,TP,1608	1	SA
...4		2007-000932	R-CHIP;47ohm,5%,1/16W,TP,1005	5	SA
...4		2007-000999	R-CHIP;510ohm,1%,1/10W,TP,1608	1	SA
...4		2007-001125	R-CHIP;68Kohm,1%,1/10W,TP,1608	4	SA
...4		2007-001139	R-CHIP;7.5Kohm,1%,1/10W,TP,1608	1	SA
...4		2007-001168	R-CHIP;75ohm,5%,1/4W,TP,3216	2	SA
...4		2007-001285	R-CHIP;5.6ohm,5%,1/16W,TP,1005	8	SA
...4		2007-001292	R-CHIP;33ohm,5%,1/16W,TP,1005	19	SA
...4		2007-001313	R-CHIP;330ohm,5%,1/16W,TP,1005	1	SNA
...4		2007-007134	R-CHIP;39Kohm,1%,1/16W,TP,1005	1	SA
...4		2007-007137	R-CHIP;1.2Kohm,1%,1/16W,TP,1005	1	SA
...4		2007-007156	R-CHIP;1ohm,5%,1/16W,TP,1005	1	SNA
...4		2007-007311	R-CHIP;22Kohm,1%,1/16W,TP,1005	5	SA
...4		2007-007313	R-CHIP;6.8Kohm,1%,1/16W,TP,1005	3	SA
...4		2007-007314	R-CHIP;5.6Kohm,1%,1/16W,TP,1005	3	SA
...4		2007-007317	R-CHIP;2.2Kohm,1%,1/16W,TP,1005	1	SA
...4		2007-007488	R-CHIP;75Kohm,1%,1/16W,TP,1005	1	SNA
...4		2007-007528	R-CHIP;1.5Kohm,1%,1/16W,TP,1005	2	SA
...4		2007-007538	R-CHIP;56Kohm,1%,1/16W,TP,1005	1	SA
...4		2007-007671	R-CHIP;11Kohm,1%,1/16W,TP,1005	1	SA
...4		2007-007698	R-CHIP;5.1Kohm,1%,1/16W,TP,1005	1	SNA

Exploded Views and Parts List

Level	Loc.	Part Code	Description & Specification	Qty.	SA/SNA
...4		2007-007766	R-CHIP;2Kohm,1%,1/16W,TP,1005	20	SA
...4		2007-007767	R-CHIP;200ohm,1%,1/16W,TP,1005	6	SA
...4		2007-007942	R-CHIP;1Mohm,1%,1/16W,TP,1005	1	SA
...4		2007-008015	R-CHIP;75ohm,1%,1/16W,TP,1005	11	SA
...4		2007-008137	R-CHIP;24Kohm,1%,1/16W,TP,1005	3	SNA
...4		2007-008263	R-CHIP;3Kohm,1%,1/16W,TP,1005	1	SA
...4		2007-008298	R-CHIP;49.9ohm,1%,1/16W,TP,1005	4	SA
...4		2007-008485	R-CHIP;22ohm,1%,1/16W,TP,1005	1	SC
...4		2007-008779	R-CHIP;0ohm,1%,1/16W,TP,1005	1	SA
...4		2007-009117	R-CHIP;49.9Kohm,1%,1/16W,TP,1005	1	SA
...4		2007-009777	R-CHIP;4.99Kohm,1%,1/16W,TP,1005	3	SA
...4		2011-001449	R-NETWORK;22ohm,5%,1/16W,L,4P,TP,1010	2	SA
...4	AD480	2203-000233	C-CER,CHIP;0.1nF,5%,50V,C0G,TP,1005	1	SA
...4	AD480	2203-000254	C-CER,CHIP;10nF,10%,16V,X7R,TP,1005	2	SA
...4	AD480	2203-000278	C-CER,CHIP;0.01nF,0.5pF,50V,C0G,TP,1005	3	SA
...4	AD480	2203-000330	C-CER,CHIP;0.012nF,5%,50V,C0G,TP,1005	4	SA
...4	AD480	2203-000359	C-CER,CHIP;0.15nF,5%,50V,C0G,TP,1005,0.5	1	SA
...4	AD480	2203-000380	C-CER,CHIP;0.015nF,5%,50V,C0G,TP,1005	2	SA
...4	AD480	2203-000385	C-CER,CHIP;0.22nF,10%,50V,X7R,TP,1005	3	SA
...4	AD480	2203-000627	C-CER,CHIP;0.022nF,5%,50V,C0G,TP,1005	1	SNA
...4	AD480	2203-000679	C-CER,CHIP;0.027nF,5%,50V,C0G,TP,1005	2	SA
...4	AD480	2203-000714	C-CER,CHIP;3.3nF,10%,50V,X7R,TP,1005	6	SA
...4	AD480	2203-000812	C-CER,CHIP;0.033nF,5%,50V,C0G,TP,1005	8	SA
...4	AD480	2203-000854	C-CER,CHIP;0.039nF,5%,50V,C0G,TP,1005	1	SA
...4	AD480	2203-000940	C-CER,CHIP;0.47nF,10%,50V,X7R,TP,1005	1	SA
...4	AD480	2203-000995	C-CER,CHIP;0.047nF,5%,50V,C0G,TP,1005	3	SA
...4	AD480	2203-001124	C-CER,CHIP;0.68nF,10%,50V,X7R,TP,1005	1	SNA
...4	AD480	2203-002711	C-CER,CHIP;100nF,10%,25V,X7R,TP,1608	16	SA
...4	AD480	2203-003019	C-CER,CHIP;8.2nF,10%,50V,X7R,TP,1005	3	SNA
...4	AD480	2203-005083	C-CER,CHIP;220nF,10%,50V,X7R,TP,1608,0.8	2	SA
...4	AD480	2203-005249	C-CER,CHIP;100nF,10%,50V,X7R,TP,1608	4	SA
...4	AD480	2203-006048	C-CER,CHIP;100nF,10%,10V,X7R,TP,1005	20	SA
...4	AD480	2203-006126	C-CER,CHIP;47nF,10%,16V,X7R,TP,1005	1	SA
...4	AD480	2203-006257	C-CER,CHIP;470nF,10%,6.3V,X5R,TP,1005,0.	3	SNA
...4	AD480	2203-006324	C-CER,CHIP;2200nF,10%,10V,X5R,TP,1608	4	SA
...4	AD480	2203-006348	C-CER,CHIP;1000nF,10%,25V,X5R,TP,1608,0.	7	SA
...4	AD480	2203-006361	C-CER,CHIP;10000nF,10%,10V,X5R,TP,2012	18	SC
...4	AD480	2203-006460	C-CER,CHIP;2200nF,10%,16V,X5R,TP,1608,-	1	SA
...4	AD480	2203-006824	C-CER,CHIP;4700nF,10%,10V,X5R,TP,1608	2	SA
...4	AD480	2203-006838	C-CER,CHIP;2200nF,10%,6.3V,X5R,TP,1005	8	SA

Level	Loc.	Part Code	Description & Specification	Qty.	SA/SNA
...4	AD480	2203-006992	C-CER,CHIP;0.33nF,5%,50V,COG,TP,1005	1	SNA
...4	AD480	2203-007306	C-CER,CHIP;10000nF,10%,25V,X5R,TP,2012,1	4	SA
...4	AD480	2203-007535	C-CER,CHIP;4.7nF,10%,50V,X7R,TP,1005	1	SA
...4		2402-001268	C-AL,SMD;100uF,20%,25V,WT,TP,8x6.3mm	2	SA
...4		2409-001338	C-POLYMER ,CHIP;47uF,20%,6.3V,TP,3.2x1.6	1	SA
...4		2703-000213	INDUCTOR-SMD;470nH,10%,1608,1.35Ohm,35mA	1	SA
...4		2703-001938	INDUCTOR-SMD;56nH,5%,1005,1.5Ohm,200mA,1	1	SA
...4		2703-003713	INDUCTOR-SMD;1.5uH,20%,7366,0.015ohm,700	4	SA
...4		2703-004724	INDUCTOR-SMD;82uH,20%,5050,4mm,0.072Ohm	4	SA
...4		2703-005192	INDUCTOR-SMD;4.7uH,20%,6060,4.5,0.036ohm	2	SA
...4		2703-005193	INDUCTOR-SMD;2.2uH,20%,6060,4.5,0.024ohm	1	SA
...4		2703-005194	INDUCTOR-SMD;3.3uH,20%,6060,4.5,0.03ohm,	1	SA
...4		2801-004477	CRYSTAL-SMD;24.576MHz,20ppm,SMD,18pF,20o	1	SA
...4		3301-001364	BEAD-SMD;1000ohm,1608,TP,1085ohm/108MHz,	7	SNA
...4		3601-001374	FUSE-SURFACE MOUNT;32V,5A,FAST-ACTING,PL	2	SA
...4		3710-004015	CONNECTOR-SOCKET;33P,1R,0.5mm,SMD-A,AU,B	1	SA
...4	EH01	3711-008131	HEADER-BOARD TO CABLE;BOX,4P,1R,2.5mm,AN	1	SA
...4	EH01	3711-008122	HEADER-BOARD TO CABLE;BOX,9P,1R,1.25mm,S	1	SA
...4	EH01	3711-008454	HEADER-BOARD TO CABLE;BOX,22P,2R,2mm,ANG	1	SA
...4	EH01	3711-008659	HEADER-BOARD TO CABLE;BOX,16P,2R,2mm,ANG	1	SA
...4		3722-003199	JACK-MODULAR;8P/8C,ANGLE,AU,1P	1	SA
...4		3722-003657	JACK-PHONE;1P/7C,P-BRONZE,BLK,ANGLE	1	SA
...4		3722-003665	JACK-PHONE;1P/7C,AU/NI,YEL,ANGLE	1	SA
...4		3722-003666	JACK-PHONE;1P/7C,AU/NI,GRN,ANGLE	1	SA
...4	JACK	3722-003837	JACK-USB;9P/1C,AU/SN/NI,BLU,SMD-A,A,3.0,	1	SA
...4		6302-001376	GASKET;D-Q47-14-180,6mm,SI	9	SNA
...4	EV01	BN40-00310B	TUNER;GT2CX-5D31,GT2CX-5D31,DVB-T2 Dual,	1	SA
...4		BN41-02356A	PCB MAIN;JU7000/JU7500,FR-4,4,A,1.2T,102	1	SNA
...4		BN97-09477A	ASSY MICOM-FLASH;T-HKMUABC,IATIN AMERICA	1	SNA
...5		1107-002357	IC-EMMC;H26M41103HPR,8Gbyte,HGA,153P,11.	1	SA
...4		BN97-09479A	ASSY MICOM-SUB;JU7K, 7.5K T-HKMDEUS-****	1	SNA
...5		1107-002226	IC-NOR FLASH;W25Q40CL,SIP,4Mbit,SOIC,8P,	1	SA
...4		BN97-09702A	ASSY MICOM-SPI;JU7500,Boston IC F/W SII9	1	SNA
...5		1107-002223	IC-NOR FLASH;W25Q16DVSSIG,16Mbit,2Mbitx8	1	SNA
...3		BN97-09484A	ASSY DRM-KEY;JU7000,7500,HDCP, MAC	1	SNA
...4		BN46-00109H	KEY CODE-CERTIFI;MAC,TV/AV,General	1	SNA
...4		BN46-00110P	KEY CODE-CERTIFI;MIRACAST(HDCP2.2), TV	1	SNA
...3	M0131	MD63-00103A	GASKET;GRANDSLAM,Conductive Fabric,1,10,	3	SNA
...2		BN94-08843A	ASSY PCB MAIN SUBCON;JU7K 75(ONLY) KOREA	1	SA
...3	AH020	BN62-00718A	HEAT SINK;Hawk_UFP Heat Sink,A1050,1.5mm	1	SNA

Exploded Views and Parts List

Level	Loc.	Part Code	Description & Specification	Qty.	SA/SNA
...3	T0527	BN68-00513A	LABEL-E,PASS;ALL MODEL, YUPO(110G),BLACK,	1	SNA
...3	T0527	BN68-00795A	LABEL-IC MICOM;MATISSE,GOYA,ART 100G,12*	1	SNA
...3		BN97-09400A	ASSY SMD;JU7000	1	SNA
...4		0202-001830	SOLDER-CREAM;LFM-48W TM-HP,D20,38um,96.5	1	SNA
...4		0403-001164	DIODE-ZENER;MMSZ5232B,5.32-5.88V,500MW,S	1	SA
...4		0406-001317	DIODE-TVS;SMAJ14A,15.6-/17.2V,400W,SMA	1	SNA
...4		0406-001556	DIODE-TVS;NUP4114UCW1,6.7V,180W,SC-88	5	SA
...4		0406-001691	DIODE-TVS;5.5V,7.0V,8.5V,0.5MAV,TP	6	SA
...4		0501-000465	TR-SMALL SIGNAL;M3T3904,NPN,350mW,SOT-2	1	SA
...4		0505-003507	FET-SILICON;AO3424,N,30V,3.8A,1.4W,SOT-2	4	SA
...4	EL02	0601-002037	LED;SMD(TOP VIEW),BLUE,1.6x0.8mm,465/470	1	SA
...4		1105-002274	IC-DDR3 SDRAM;K4B1G164CG-ECMA,DDR3 1866,	4	SNA
...4		1203-004363	IC-VOL. DETECTOR;SOT-23,3Z30,2.9x1.6mm,P	1	SA
...4		1203-007707	IC-POSADJUST REG.;AP7362ADJ,SO-8EP,8Z3	1	SA
...4		1203-008118	IC-DC/DC CONVERTER;AOZ3013P,SO-8,8P,4.9	3	SA
...4		1203-008391	IC-DC/DC CONVERTER;AOZ1269QI-02,QFN-23L	1	SA
...4		1204-003609	IC-VIDEO PROCESS;SDP1403,FCPBGAH,1000P,2	1	SA
...4	IS01	1209-002183	IC-SENSOR;S-3851AAA-M6T1U,SOT,6Z30,2.9x1	1	SA
...4		2007-000109	R-CHIP;1Mohm,5%,1/10W,TP,1608	1	SA
...4		2007-000137	R-CHIP;2Kohm,5%,1/16W,TP,1005	6	SA
...4		2007-000138	R-CHIP;100ohm,5%,1/16W,TP,1005	24	SA
...4		2007-000140	R-CHIP;1Kohm,5%,1/16W,TP,1005	1	SNA
...4		2007-000143	R-CHIP;4.7Kohm,5%,1/16W,TP,1005	24	SA
...4		2007-000177	R-CHIP;0ohm,5%,1/16W,TP,1005	11	SA
...4		2007-000239	R-CHIP;1.5Kohm,1%,1/10W,TP,1608	1	SNA
...4		2007-000614	R-CHIP;24Kohm,1%,1/10W,TP,1608	1	SNA
...4		2007-007107	R-CHIP;100Kohm,1%,1/16W,TP,1005	3	SA
...4		2007-007132	R-CHIP;15Kohm,1%,1/16W,TP,1005	2	SA
...4		2007-007135	R-CHIP;18Kohm,1%,1/16W,TP,1005	1	SNA
...4		2007-007136	R-CHIP;4.7Kohm,1%,1/16W,TP,1005	2	SA
...4		2007-007138	R-CHIP;27Kohm,1%,1/16W,TP,1005	1	SA
...4		2007-007139	R-CHIP;47Kohm,1%,1/16W,TP,1005	5	SA
...4		2007-007142	R-CHIP;10Kohm,1%,1/16W,TP,1005	8	SA
...4		2007-007306	R-CHIP;100ohm,1%,1/16W,TP,1005	9	SA
...4		2007-007308	R-CHIP;33Kohm,1%,1/16W,TP,1005	1	SA
...4		2007-007309	R-CHIP;12Kohm,1%,1/16W,TP,1005,0.35T	1	SA
...4		2007-007310	R-CHIP;8.2Kohm,1%,1/16W,TP,1005	2	SA
...4		2007-007312	R-CHIP;20Kohm,1%,1/16W,TP,1005	3	SA
...4		2007-007315	R-CHIP;3.9Kohm,1%,1/16W,TP,1005	1	SNA
...4		2007-007318	R-CHIP;1Kohm,1%,1/16W,TP,1005	19	SA

Level	Loc.	Part Code	Description & Specification	Qty.	SA/SNA
...4		2007-007334	R-CHIP;200Kohm,1%,1/16W,TP,1005	4	SNA
...4		2007-007517	R-CHIP;240ohm,1%,1/16W,TP,1005	11	SA
...4		2007-007590	R-CHIP;82Kohm,1%,1/16W,TP,1005	1	SNA
...4		2007-007627	R-CHIP;16Kohm,1%,1/16W,TP,1005	3	SA
...4		2007-007842	R-CHIP;21.5Kohm,1%,1/10W,TP,1608	1	SA
...4		2007-007861	R-CHIP;62Kohm,1%,1/16W,TP,1005	1	SA
...4		2007-008213	R-CHIP;4.3Kohm,1%,1/16W,TP,1005	1	SNA
...4		2007-008332	R-CHIP;11.5Kohm,1%,1/16W,TP,1005	1	SA
...4		2007-010387	R-CHIP;10Kohm,1%,1/16W,TP,1005	1	SA
...4	AD480	2203-000332	C-CER,CHIP;0.01uF,5%,50V,C0G,TP,1608	2	SA
...4	AD480	2203-000438	C-CER,CHIP;1uF,10%,50V,X7R,TP,1005	2	SA
...4	AD480	2203-000489	C-CER,CHIP;2.2nF,10%,50V,X7R,TP,1005	3	SA
...4	AD480	2203-000975	C-CER,CHIP;47nF,10%,25V,X7R,TP,1608	1	SA
...4	AD480	2203-002285	C-CER,CHIP;10nF,10%,50V,X7R,TP,1005	1	SA
...4	AD480	2203-005344	C-CER,CHIP;22nF,10%,25V,X7R,TP,1005,0.5T	2	SNA
...4	AD480	2203-005968	C-CER,CHIP;4.7nF,10%,50V,X7R,TP,1005,0.5	2	SA
...4	AD480	2203-006158	C-CER,CHIP;100nF,10%,16V,X7R,TP,1005,0.5	207	SA
...4	AD480	2203-006562	C-CER,CHIP;1000nF,10%,10V,X5R,TP,1005	2	SA
...4	AD480	2203-006698	C-CER,CHIP;1000nF,10%,25V,X7R,TP,1608,0.	2	SNA
...4	AD480	2203-007240	C-CER,CHIP;22000nF,20%,6.3V,X5R,TP,1608(15	SA
...4	AD480	2203-007269	C-CER,CHIP;22000nF,20%,10V,X5R,TP,2012(2	6	SA
...4	AD480	2203-007270	C-CER,CHIP;10000nF,10%,10V,X5R,TP,1608,0	65	SNA
...4	AD480	2203-007544	C-CER,CHIP;100nF,10%,50V,X7R,TP,1005,0.5	6	SA
...4		2703-003937	INDUCTOR-SMD;1uH,20%,7.0x6.47x3.0mm,0.00	1	SA
...4		2703-004589	INDUCTOR-SMD;2.2uH,20%,5050,2T,0.048Ohm,	2	SA
...4		2703-004845	INDUCTOR-SMD;4.7uH,20%,3838,1.8T,0.075Oh	1	SA
...4		2801-005324	CRYSTAL-SMD;27MHz,30ppm,Ceramic SMD(4pin	1	SA
...4		3301-002039	BEAD-SMD;26ohm,1608/TP	15	SA
...4		3601-001376	FUSE-SURFACE MOUNT;32V,3A,FAST-ACTING,Hi	1	SA
...4		3708-003073	CONNECTOR-FPC/FFC/PIC;51P,0.5mm,SMD,AU,N	2	SA
...4		3708-003183	CONNECTOR-FPC/FFC/PIC;41P,0.5mm,SMD-A,AU	1	SA
...4		3711-007839	CONNECTOR-HEADER;BOX,15P,1R,1.25mm,SMD-A	1	SA
...4		6302-001290	GASKET;SMR-TS-4-4.5-3.40mm,Ni+Au+SUS+Mg	6	SNA
...4		BN41-02417A	PCB MAIN;Hawk-UFR(4K,SDC),FR-4,4,1.2T,1	1	SNA
...4		BN68-01078A	LABEL-IC MICOM;7mm,7mm,WHITE	1	SNA
...4		BN68-02016A	LABEL;LS19MYMKBQ/XSJ,JAPAN,FLOURESCENT,1	1	SNA
...4		BN97-09545A	ASSY MICOM-FLASH;HAWK_UFP_XXXX,UJ7*,UWJ5	1	SNA
...5	IC	1107-002265	IC-NOR FLASH;W25Q32FVSSIG,32Mbit,SOP,8P,	1	SA
1		BN91-14742A	ASSY SHIELD;JS7K 75	1	SNA
.2	SCREW	6001-002789	SCREW-MACHINE;BH,+,M4,L6,ZPC(WHT),SWRCH1	1	SA

Exploded Views and Parts List

Level	Loc.	Part Code	Description & Specification	Qty.	SA/SNA
.2	SCREW	6001-003016	SCREW-MACHINE;PWH,+ ,M3.0,L5.0,ZPC(WHT),S	17	SA
.2	M-F	BN39-01990D	LEAD CONNECTOR-FUNCTION;JU7K,FLAT Connec	1	SA
.2	EC13	BN39-02002B	LEAD CONNECTOR;BLU Harness,Lead Connecto	1	SA
.2	EC13	BN39-02003A	LEAD CONNECTOR;BLU Harness,Lead Connecto	1	SA
.2	EC13	BN39-02017E	LEAD CONNECTOR;FLAT CONNECTOR ASS'Y,Lead	1	SA
.2	EC13	BN39-02032C	LEAD CONNECTOR;FLAT CONNECTOR ASS'Y,Lead	1	SA
.2	EC13	BN39-02037A	LEAD CONNECTOR;JU7.5k/7k,Lead Connector*	1	SA
.2	EC13	BN39-02067A	LEAD CONNECTOR;FLAT CONNECTOR ASS'Y,Lead	1	SA
.2	P001A	BN44-00813A	DC VSS-LED TV PD BOARD;L78S7N_FSM,L78S7N_FS	1	SA
.2	NW01	BN59-01194F	NETWORK;11ac Combo,Internal WiFi,USB 2.0	1	SA
.2		BN61-11928A	HOLDER-SIDE AV;JU7500,HIPS,LATIN,1 TUNNE	1	SNA
.2		BN62-00730A	PAD GAP;Silicone Thermal Pad,14T,20,20,3	1	SNA
.2		BN62-00731A	PAD GAP;HS01-13040-SST-3535,Silicone The	1	SNA
.2	SP01A	BN96-35006D	ASSY SPEAKER P;6ohm,4pin,10W,JU6400 65"	1	SA
.2		BN96-35345B	ASSY BOARD P-FUNCTION_SW;JU7500,Function	1	SA
.2	FB01A	BN96-35346B	ASSY BOARD P-FUNCTION ASSY;JU7500,Funci	1	SA
.2	FL06	BN96-35462R	ASSY CABLE P;UN75JU7000,FFC,NH,293mm,51P	1	SA
.2	FL06	BN96-35462T	ASSY CABLE P;UN75JU7000,FFC,NH,215mm,51P	1	SA
.2	FL06	BN96-35850B	ASSY CABLE P;UN75JU7000,FFC,NH,215mm,41P	1	SA
.2	SB05A	BN96-37262B	ASSY BRACKET P-STAND LINK;JU7K 75",SECC	1	SNA
...3	CB18	BN61-11518B	BRACKET-STAND LINK;JU7000 75",EGI-SECC A	1	SNA
...4		BN61-09605A	BRACKET STOPPER NUT;LED TV F6100 Others	4	SNA
...3	M0131	BP63-00223A	GASKET;HLN507W1X/XAA,Conductive Fabric,2	2	SNA
1		BN92-17045C	ASSY LABEL;JU7000	1	SNA
.2		BN02-00102B	TAPE-FILAMENT;#8917,0.15,25.50,WHITE	0	SNA
.2		BN68-04577B	LABEL-STICKER;TV ALL,XY,ART PAPER,T0.05,	1	SNA
.2		BN68-05220A	LEAFLET-02,QR CODE;ALL,XY,W/P80G	1	SNA
.2		BN68-06708E	LABEL RATING;ALL,W,W,PP,T0.05,93,73,Dark	1	SNA
.2		BN68-07062S	LABEL ENERGY;UA75JU7000WXXY,XY,PET,T0.1,	1	SNA
.2		BN68-07069B	LEAFLET-QSG;JU7000,ASIA,ART*,B4-B5	1	SNA
1	ACCE1	BN92-17120B	ASSY ACCESSORY;JU7000	1	SNA
.2		BN96-35817H	ASSY BOARD P-ONE CONNECT MINI;one connec	1	SA
...3		BN39-02014A	CBF SIGNAL-OCM;OCM,33P*,AXIAL,3000,UL,BL	1	SA
...3		BN96-35817B	ASSY BOARD P-ONE CONNECT MINI;one connec	1	SA
.2		BN96-36097B	ASSY ACCESSORY MANUAL/CABLE;JU7000	1	SNA
...3	T0268	3903-000435	CBF-POWER CORD,DT,AU,IP3/YES,IEC320 C13-	1	SA
...3		4301-000101	BATTERY-ALKALINE;1.5V,1650mAh,LR6,14.5x5	2	SNA
...3	EC08	BN39-01154C	CBF SIGNAL;Chelsea Slim, STEREO Plug to	1	SA
...3	EC07	BN39-01154H	CBF SIGNAL;UE40B7000WWXXC,3P RCA,30AWG,1	1	SA
...3		BN59-01220D	REMOCON-15SMART CONTROL;TM1560,18,70mA,3	1	SA

Level	Loc.	Part Code	Description & Specification	Qty.	SA/SNA
..3		BN68-02298C	LABEL-STICKER;TV,XY,ART,T0.05,93,40,XY C	1	SNA
..3		BN68-03016A	LABEL;LS19MYMKBQ/XSJ,JAPAN,FLOURESCENT,1	1	SNA
..3		BN68-04972E	LEAFLET-04,REGULATORY GUIDE;ALL,SAMSUNG,	1	SNA
..3		BN68-05497A	LABEL;ART 100G,23mm,60mm,Blue,White Blan	1	SNA
..3		BN68-05608B	LEAFLET-SMART TV PROMOTION GUIDE;SMART T	1	SNA
..3		BN68-05971A	LEAFLET-01,WARRANTY CARD;comm,Samsung,Au	1	SNA
..3		BN68-07160A	MANUAL USERS-01;JU7000,ASIA DTV,W/P,ENG	1	SNA
..3		BN69-10158A	BOX ACCESSORY;H8000_ACCESSORY,CB,SERP Re	1	SNA
..3		BN69-10161A	PAD-TYPE;H8000_ACCESSORY,CB,SERP Recycle	1	SNA
..3		BN69-10225B	WRAP VINYL-SHRINK;ACCESSORY BOX,PLASTIC	0	SNA
..3		BN69-11826A	PAD ACCESSARY;JQ8500 ACCESSORY-BOX-REMOC	1	SNA
1		BN92-17362D	ASSY LABEL POP;JU7K	1	SNA
.2		BN68-07190A	LABEL POP-01,HIGHLIGHT STICKER;JU7000,PE	1	SNA
1		BN92-17998A	ASSY P/MATERIAL;JU7K 75	1	SNA
.2		0203-001595	TAPE-OPP MASKING;OPP-2,0.075,75,800M,CLR	2	SNA
.2		6902-000609	BAG ROLL;LDPE,T0.05,W2400,L1000,TRP,30.0	0	SNA
.2		6902-001684	BAG PE;HDPE/PE FOAM,T0.015/T0.5,W2000,L1	1	SNA
.2		6922-000013	BAND;PP,W18,L2300/L2900,TRP	7	SNA
.2	T0214	AA61-20285C	HOLDER-BOX;CORAL,PP,BLACK HB,17.5g	4	SNA
.2		BN69-00391Y	PAD-ANGLE;CB,T5 W2100,L50,VEL,403g	1	SNA
.2		BN69-11231A	CUSHION-SET;JU7000 75",EPS,W/W	1	SNA
.2		BN69-11264A	CUSHION-SIDE;JU7000 75",EPS	2	SNA
.2		BN69-11504A	WRAP VINYL-CKD;LDPE,0.018,W500,L10000,TR	13	SNA
1		BN92-18005B	ASSY BOX;JU7K 75	1	SNA
.2		BN68-00662A	LABEL BOX-01,ALL MODEL,ART PAPER,60,110,	1	SNA
.2		BN69-11644F	BOX UNIT-SET,OUT;75JU7000-TS,CB,C-03,DW4	1	SNA
.2		BN69-11645A	BOX UNIT-SET,IN;75HU7000-TS,CB,C-01,DW	1	SNA