



## 1. EXPLODED VIEWS AND PARTS LIST

### [MATERIAL CODE STANDARDS]

Material codes and names and their respective naming rules are managed in accordance with the prescribed standards. Please refer to these standards when requesting a material.

#### 1. Material Code Type

- : Number
- : Letter (Alphabet)

<b>Type 1</b>	 ex) 0204-000418 FREON	<b>Enterprise-wide parts</b> Type 1 materials can be used for all Samsung Electronics products. (Most electrical parts belong to this type.)
<b>Type 2</b>	 ex) DC96-01390A ASSY-CONTROL	<b>Division-wide parts (DC**-Washing machine)</b> Type 2 materials can be used for specific products. (Most instruments and tools belong to this type.)

#### 2. Ass'y Materials

All ass'y material codes start with DC9\*.

An ass'y material is created by combining more than two materials. If a requested material cannot be provided, you can request an ass'y material that contains that material.

1-1. MAIN

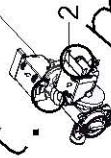
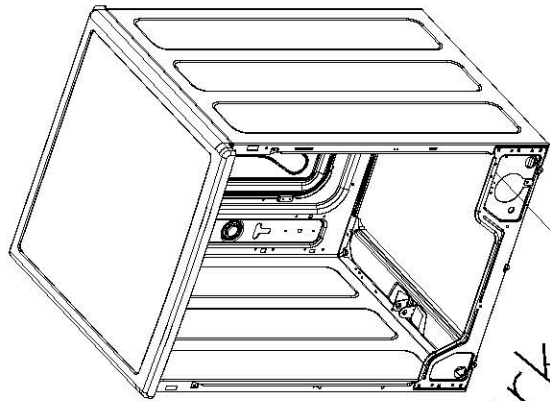

	13		12	
		10		11
		9		10
	8	8		5

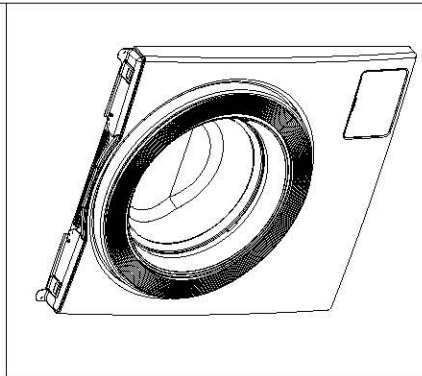
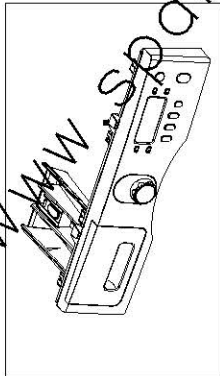
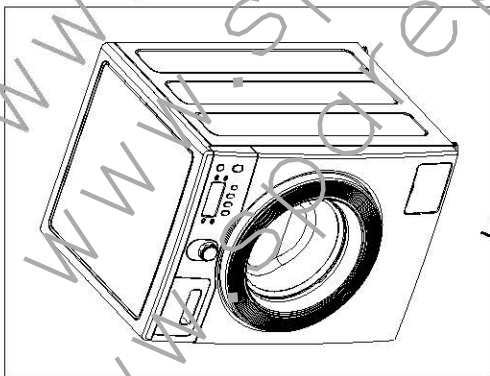
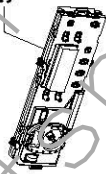
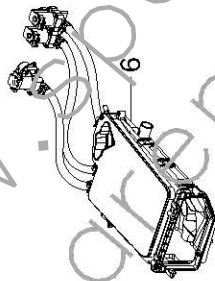

3

**MODEL CODE: WF1752WPC/XSA**

Service Bom (SA: SERVICE AVAILABLE, SNA: SERVICE NOT AVAILABLE)

Drawing No.	Code No.	Description	Specification	QTY	Un	SA/SNA
2	DC97-15696J	ASSY PUMP DRAIN	HEBA DD,BUBBLE,(220~240V	1	PC	SNA
3	DC97-16454A	ASSY FRAME FRONT	HEBA-PJT,WF8804DPA/XEO,	1	PC	SA
5	DC92-00655D	ASSY PCB SUB	P171,Vistula better sub,WF1	1	PC	SA
6	DC97-16005J	ASSY HOUSING DRAWER	VISTULA,WF1804WPC/XE	1	PC	SA
7	DC90-09343A	ASSY TUB&DRUM	VISTULA,WF1702WPU/YL	1	PC	SNA
8	DC67-00208B	CAP-FIXER	WF8692NHS/XFA,PP,T1.5,P535-H,B	1	PC	SA
9	DC60-00104A	FASTENER-BOLT	ALL,CR,OD36,2.5 L.113.5	1	PC	SA
10	DC67-00307A	CAP-FIXER	WF438AAC/XAA,PP,T1.5,RECYCLE,B	4	PC	SA
11	DC67-00230E	HOSE WATER	WD8704,TPE,ID4.5,GRY	1	PC	SNA
12	DC97-16921A	ASSY HOSE WATER	HEBA,WF8804,REFLEX,BLUE/	1	PC	SA
13	DC62-10278A	HOSE HANGER	PUMP MODEL,PP,BLACK	1	PC	SA

1-2. FRAME & COVER PARTS

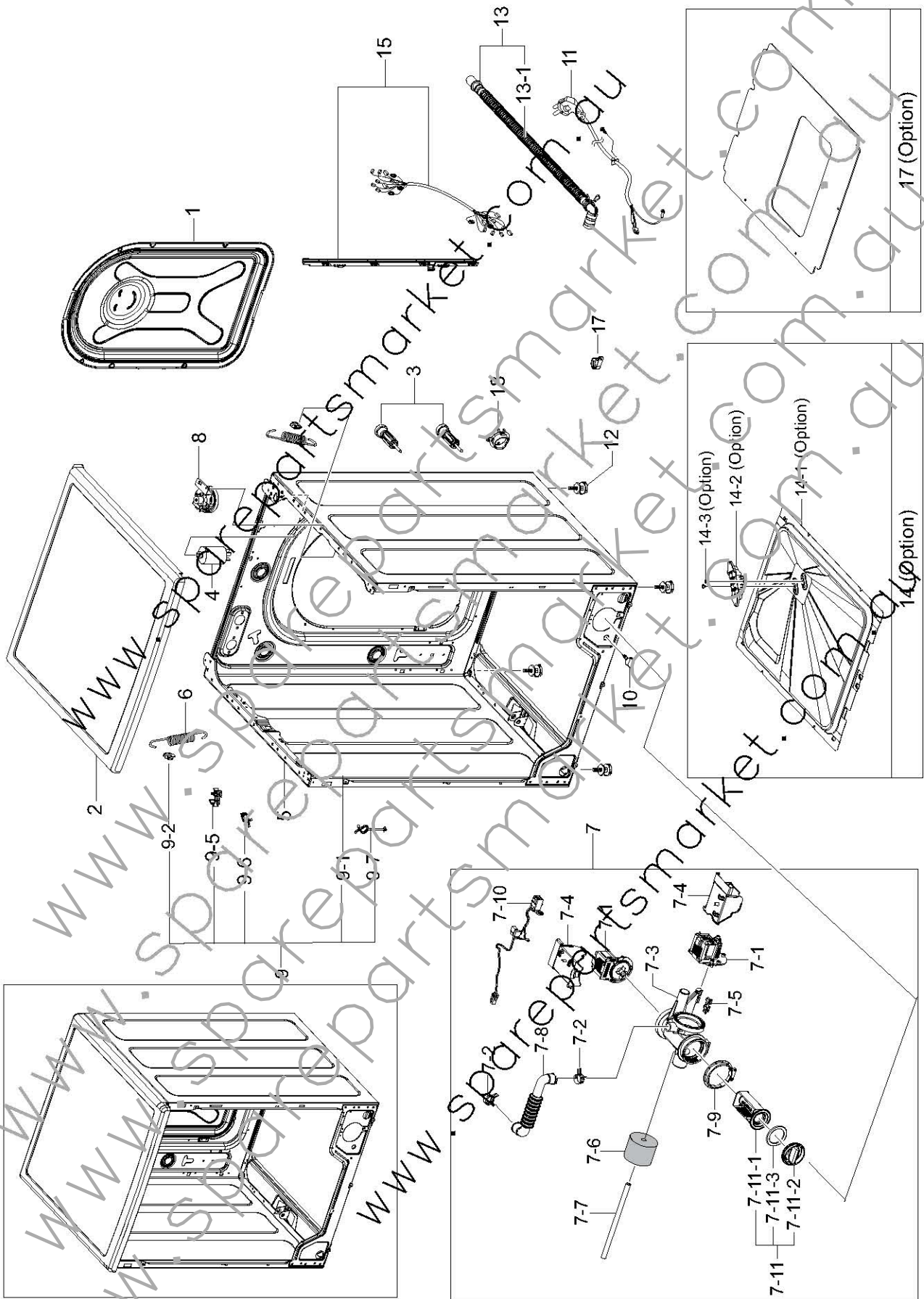

**MODEL CODE: WF1752WPC/XSA**

Service Bom (SA: SERVICE AVAILABLE, SNA: SERVICE NOT AVAILABLE)

Drawing No.	Code No.	Description	Specification	QTY	Un	SA/SNA
1	DC63-00862C	COVER BACK	WF8600NMW,GI-SGCC,T0.35,W352,	1	PC	SA
2	DC97-14953A	ASSY COVER TOP	HEBA-PJT,-,WOOD+AL,FOIL+U	1	PC	SA
3	DC97-14794C	ASSY FIXER TUB	SCOUT,WF0704L7W/XEF	4	PS	SA
4	DC29-00005A	FILTER-EMI	P/PV-PJT,260V,15,D38*51(+BOLT	1	PC	SA
5	DC97-16466A	ASSY FRAME PLATE(U)	HEBA-SSEC PJT,WF8804	1	PC	SA
6	DC61-02029B	SPRING ETC-HANGER	HEBA 7kg,HSWR-SWRH,C03	2	PC	SA
7	DC97-15696J	ASSY PUMP DRAIN	HEBA DD,BUBBLE,(220~240V	1	PC	SNA
7-1	DC31-30008D	PUMP-DRAIN	SW-70XP,220/240V,50Hz,SYNCHRO	2	PC	SA
7-2	DC61-00158A	CLAMPER HOSE	SW65ASF,SK5,ID23,T0.8,-	2	PC	SNA
7-3	DC61-02271B	CASE PUMP	WF0814Y8E/XEF,PP,T2.5,W153.6,L	1	PC	SNA
7-4	DC63-01410A	COVER PUMP	COVER-PUMP,PP,T1.3,W50,L77,V0	2	PC	SNA
7-5	DC63-00905A	CUSHION PUMP	WF8802DPF/XE T,NBR,-,W37.6,L	1	PC	SNA
7-6	DC63-10003C	SPONGE HOSE AIR	SWF-P12,PU-FOAM,GRY	1	PC	SNA
7-7	DC67-00244M	HOSE DRAIN	AEGIS,EPDM,1D6,OD10,T2.0,L270	1	PC	SNA
7-8	DC67-00461A	HOSE AIR TUB	SCOUT-PJT,EPDM,T1.5,BLK	1	PC	SNA
7-9	DC69-01128A	PACKING-PUMP	WF0804DP,IIR,BUTYL,T2.5,HEB	1	PC	SNA
7-10	DC93-00016C	ASSY WIRE HARNESS-PUMP	DRUM,SCOUT,CIRCUL	1	PC	SNA
7-11	DC97-15695C	ASSY FILTER	Heba,WF9904CWN1	1	PC	SNA
7-11-1	DC63-00998A	FILTER PUMP	SCOUT-PJT,PP-,W52.8,L93.1,	1	PC	SA
7-11-2	DC64-02783A	HANDLE FILTER	WF350ANW/XAA,PP,T2.3,W63.8	1	PC	SA
7-11-3	DC73-00022A	SEAL PACKING	SEVV-HVR149ATA,EPDM,BLK,-	1	PC	SA
8	DC96-01703A	ASSY SENSOR PRESSURE	Hook	1	PC	SA
9	DC97-17089B	ASSY PAINT FRAME	VISTULA,WF1752WPW/XSA,7	1	PC	SA
9-1	DC97-16439L	ASSY FRAME	VISTULA,WF1704YPC/XEF,PCM(SI)	1	PC	SNA
9-2	DC61-02065A	GUIDE SPRING	WF418AAG/XXA,POM,T4,W24,L36	2	PC	SA
9-5	DC61-00133A	CLAMPER HOSE-FIX	P1291,PP-,HOSE+PLUS,BJ	1	PC	SA
9-6	DC61-40091A	HOLDER WIRE	DAWH-2NC,PA,-,NATURAL,-	9	PC	SA
9-7	DC61-00995C	HOLDER WIRE	HEBA-PJT,PA,-,NATURAL,-,2110	1	PC	SA
10	DC61-10673C	CAP DRAIN	WF1802XEF,XSC,FRPP,BLACK	1	PC	SA
11	DC90-10841D	ASSY POWER CORD	SAA,AP3,250V/10A,H05VV-F	1	PC	SA
12	DC97-00920C	ASSY LEG	SWH-HW108,L48.5,M10	4	PC	SA
13	DC97-02250Z	ASSY HOSE DRAIN(O)	HEBA-PJT,GRY	1	PC	SA
13-1	DC62-10022G	HOSE PUMP	SWF-P12,PP,ID20.5,L1980,-,-,WH	1	PC	SNA
14	DC97-16443C	ASSY COVER BOTTOM	VISTULA 6A MODEL,WF180	1	PC	SA
14-1	DC63-01250A	COVER-BOTTOM	HEBA-SSEC,GI-SGCC,T0.5,W422	1	PC	SNA
15	DC93-00273A	ASSY M.GUIDE WIRE HARNESS	VISTULA,WF1804	1	PC	SA
17	DC61-00118A	CLAMPER HOSE-FIX	P1291,PA66,ID27,OD30	1	PC	SA
18	DC61-02646A	GUIDE HOSE	WF0804Y8E,PP,T2.0,W9.8,L36.6,	2	PC	SNA

1-3. ASS'Y TUB DRUM

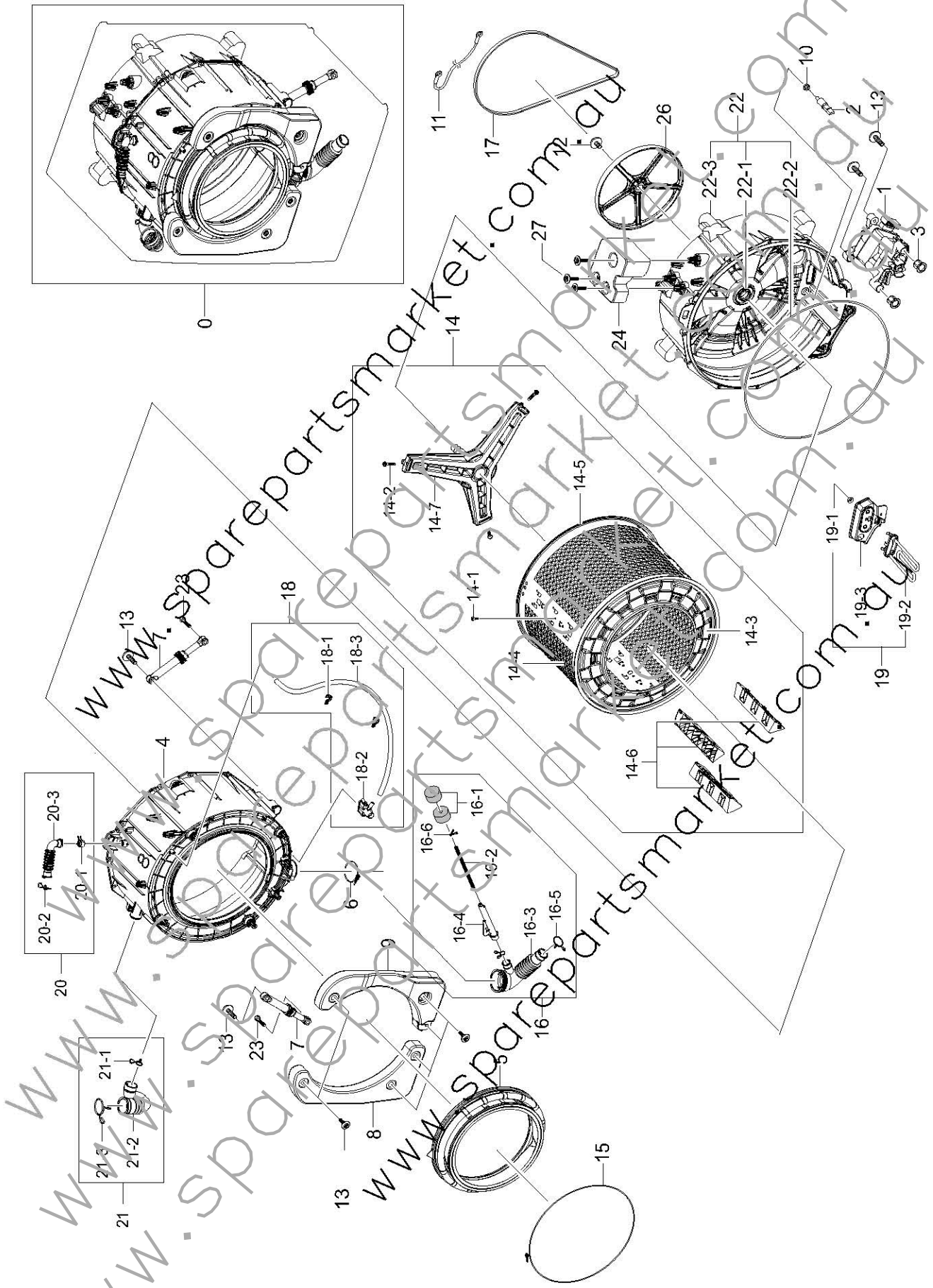

**MODEL CODE: WF1752WPC/XSA**

Service Bom (SA: SERVICE AVAILABLE, SNA: SERVICE NOT AVAILABLE)

Drawing No.	Code No.	Description	Specification	QTY	Un	SA/SNA
0	DC90-09343A	ASSY TUB&DRUM	VISTULA,WF1702WPU/YL	1	PC	SNA
1	DC31-00123B	MOTOR UNIVERSAL-DRUM	Welling(UML 5202.01	1	PC	SA
2	DC32-00010A	THERMISTOR	-,11982OHM AT 25°C,-,55~155,-	1	PC	SNA
3	DC61-02549A	BUSH MOTOR	HEBA BIGBANG,PA66+GF15%,NATUR	1	PC	SNA
4	DC61-01933C	TUB FRONT	HEBA PJT,FRPP,ID528,OD575,NYR	1	PC	SNA
5	DC64-01602A	DOOR DIAPHRAGM	HEBA PJT,EPDM,T1.5,-,GRAY	1	PC	SA
6	DC65-00021A	CLAMPER HOSE-JOINT	HEBA PJT,HSWR-SWRH,ID	1	PC	SNA
7	DC66-00421B	DAMPER SHOCK	HEBA-SSEC PJT,PP,L215,80N	2	PC	SC
8	DC97-16008A	ASSY WEIGHT BALANCER-LEFT	SCOUT-PJT,WF08	1	PC	SA
9	DC97-15966A	ASSY WEIGHT BALANCER-RIGHT	SCOUT PJT,WF0	1	PC	SA
10	DC69-00824A	PACKING-THERMISTOR	GW-PJT,EPDM,-,W17,H	1	PC	SNA
11	DC93-00015A	ASSY WIRE EARTH	AEGIS,5KG,230V/50HZ,EART	1	PC	SA
12	6011-001498	BOLT-HEX	M10,L27,ZPC(YEL),SWRCH 0AK,WS/N	1	PC	SA
13	DC97-14263A	ASSY BOLT	HEBA-PJT,MOTOR/BOLT(M8)+WASHER	4	PC	SA
13	DC97-14263A	ASSY BOLT	HEBA-PJT,MOTOR/BOLT(M8)+WASHER	4	PC	SA
13	6011-003934	BOLT-HEX	M7.6,L48,ZPC(WHT),SCM 435,WASHE	9	PC	SA
13	6011-003934	BOLT-HEX	M7.6,L48,ZPC(WHT),SCM 435,WASHE	9	PC	SA
14	DC97-14373N	ASSY DRUM	SSEC HEBA,WF8702LSW1/YLV,7KG,1	1	PC	SA
14-1	6002-001006	SCREW-TAPPING	TH,+,-,2S,M4,L12,PASS,STS4	3	PC	SNA
14-2	DC60-40137A	BOLT HEX	MARS-PJT,STAINLESS-STS430,M8,PA	3	PC	SA
14-3	DC66-00489A	DRUM FRONT	HEBA PJT,STAINLESS-STS430,ID6	1	PC	SNA
14-4	DC66-00501A	DRUM WRAPPER	HEBA PJT 7.0kg,STAINLESS ST	1	PC	SNA
14-5	DC66-00492A	DRUM BACK	HEBA PJT,STAINLESS-STS430,ID48	1	PC	SNA
14-6	DC66-00493A	DRUM LIFTER	HEBA PJT,PP,TI42,GRAY,7/8KG	3	PC	SA
14-7	DC97-16677B	ASSY FLANGE SHAFT	SSEC HEBA,WF8802DPA1,1	1	PC	SA
15	DC91-12077G	ASSY CLAMP DIAPHRAGM	AEGIS,WF6500NHW/YLP	1	PC	SA
16	DC97-14637G	ASSY HOSE PRESSURE	SCOUT COMBO,WD0804W8N	1	PC	SA
16-1	DC63-10003H	ABSORBER SPONGE	SPONGE-HOSE AIR,PU-FOAM,	1	PC	SNA
16-2	DC67-00230E	HOSE WATER	WD8704,TPE,ID4.5,GRY	1	PC	SNA
16-3	DC67-00293A	HOSE FILTER TUB	HEBA-PJT,EPDM,-,T2.5,-	1	PC	SA
16-4	DC67-00598A	HOSE JOINT AIR	WD0804W8N1/YAH,PP,ID36.2,	1	PC	SNA

**MODEL CODE: WF1752WPC/XSA**

Service Bom (SA: SERVICE AVAILABLE, SNA: SERVICE NOT AVAILABLE)

Drawing No.	Code No.	Description	Specification	QTY	Un	SA/SNA
16-5	DC72-00001H	CLIP RING	HEBA-PJT,HSWR-SWRH,PI3.0,ID35,	1	PC	SNA
16-6	DC61-70029C	CLIP RING	SEW-HW125,HSWR,WHITE	2	PC	SNA
17	6602-001497	BELT-TIMING GEAR	RUBBER(GATES),T3.2,1270	1	PC	SA
18	DC97-15993A	ASSY HOSE CIRCULATION	SCOUT,WF0804Y8E,EP	1	PC	SA
18-1	DC61-02646A	GUIDE HOSE	WF0804Y8E,EP,T2.0,W9.8,L36.6,	2	PC	SNA
18-2	DC67-00462A	HOSE CONNECTOR	WF0804Y8E,PP,NTR,SCOUT-P.J.	1	PC	SNA
18-3	DC67-00471A	HOSE CIRCULATION	WF0804Y8E,EPDM,ID9.0,OD	1	PC	SNA
19	DC47-00033B	HEATER-WASH	HEBA,SUS316L,2000,8.69,230V,	1	PC	SA
19-1	DC60-60044B	WASHER PLAIN	SBC,ID8.4/OD30,T2.0	4	PC	SA
19-2	DC47-00033B	HEATER-WASH	HEBA,SUS316L,2000,8.69,230V,	1	PC	SA
19-3	DC63-00889C	COVER HEATER	HEBA ABS+PC,T3.0,5V-A,NATUR	1	PC	SNA
20-1	DC65-60118J	CLIP RING	HSWR-SWRH,-,PI2.0,ID23	1	PC	SNA
20-1	DC65-60118R	CLIP RING	AEGIS-PJT,HSWR-SWRH,T3.0,ID37,	1	PC	SA
20-2	DC67-00354A	HOSE AIR	HEBA PJT,EPDM,BLK,7kg	1	PC	SA
21	DC97-16005J	ASSY HOUSING DRAWER	VISTULA,WF1804WPC/XE	1	PC	SA
21-1	DC65-00008B	CLAMPER HOSE	SSEC-GE,SK5,ID14.2,ZPC2,T1.	4	PC	SNA
21-2	DC67-00422A	HOSE DRAWER TUB	HEBA-PJT,EPDM,BLK	1	PC	SC
21-3	DC72-00001G	CLIP RING	HEBA-PJT,HSWR-SWRH,T3.0,ID49.5	1	PC	SNA
22	DC97-16462B	ASSY SEMI TUB BACK	Heba PJT,WF8802SPG1/X	1	PC	SA
22-1	DC62-00008A	SEAL OIL	NBR,BLACK,-,NBU	1	PC	SA
22-2	DC69-01154A	PACKING-TUB	WF8804DP,EPDM,-,L1650	1	PC	SA
22-3	DC61-01934D	TUB BACK	WF8802LSW,FRPP,528,575,HEBA 120	1	PC	SNA
23	DC60-40144A	BOLT HEX	SM10C,L35,ZPC2(YEL),M10,ZPC2(YE	2	PC	SA
24	DC67-00582B	WEIGHT BALANCER-UP	HEBA-PJT,CONCRETE,T89	1	PC	SA
25	DC63-00889C	COVER HEATER	HEBA,ABS+PC,T3.0,5V-A,NATUR	1	PC	SNA
26	DC66-00300A	PULLEY MOTOR	HEBA PJT,ALDC,OD296.8,1400R	1	PC	SA



1.4. ASS'Y FRAME FRONT

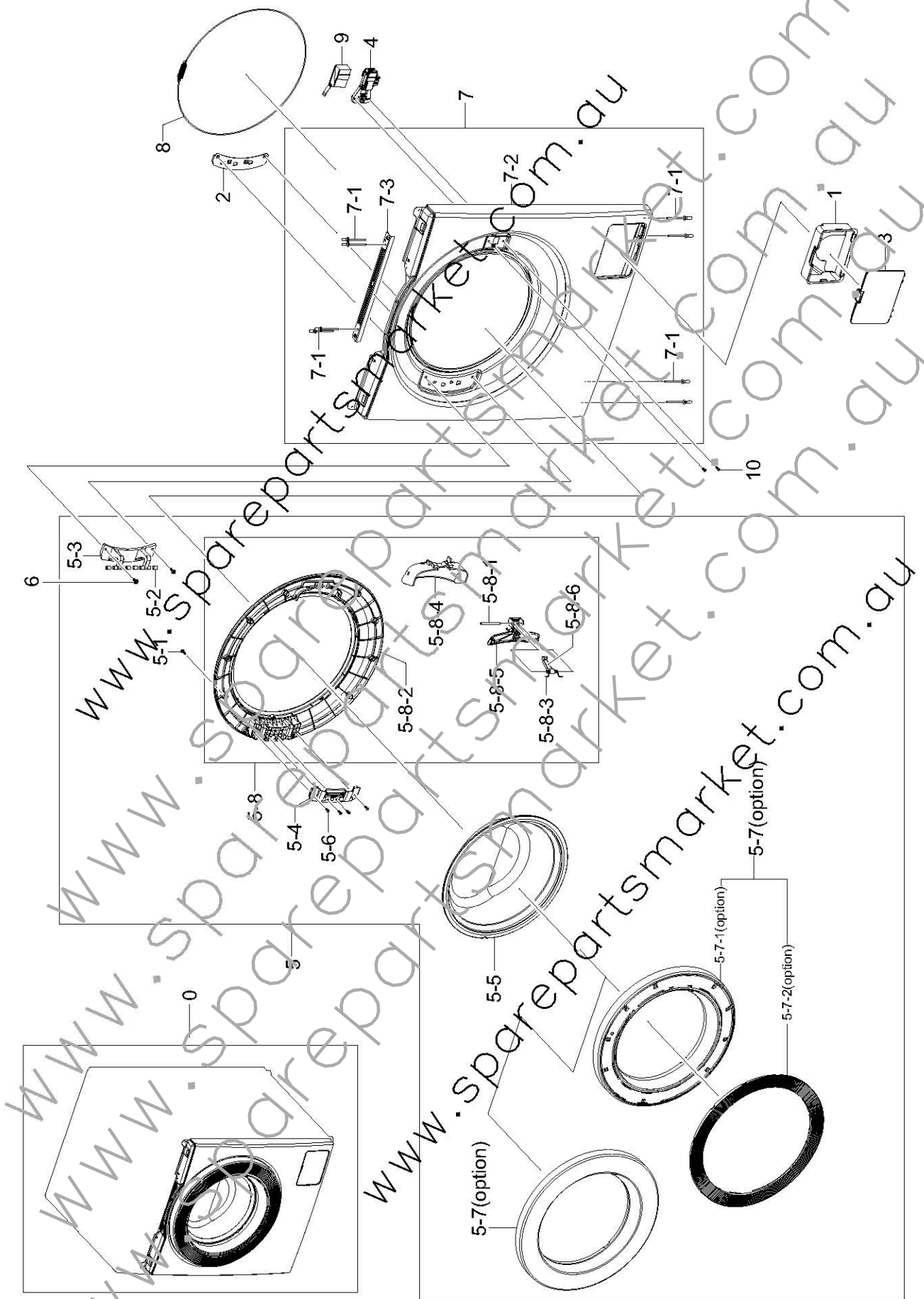

**MODEL CODE: WF1752WPC/XSA**

Service Bom (SA: SERVICE AVAILABLE, SNA: SERVICE NOT AVAILABLE)

Drawing No.	Code No.	Description	Specification	QTY	Un	SA/SNA
0	DC97-16454A	ASSY FRAME FRONT	HEBA-PJT,WF8804DPA/XEO,	1	PC	SA
1	DC61-01917B	GUIDE FILTER	WF8804DP,PPT2.0,W118.9,L14	1	PC	SA
2	DC61-01919A	BRACKET HINGE	WF8804DP,GI-SGCC,T1.4,L161	1	PC	SA
3	DC63-01516A	COVER-FILTER	WF8804DPA,ABS,T2.5,115.7,15	1	PC	SA
4	DC64-01538A	DOOR-LOCK SAW	Z7-446L5,PA,W95,L52,WHITE,	1	PC	SA
5	DC97-15005N	ASSY DOOR	HEBA,WF1804WPC,YFQ	1	PC	SNA
5-1	6002-001554	SCREW-TAPPING	TH,+,No,1,M4,L12,STS430,HE	12	PC	SNA
5-2	DC61-00891A	GUIDE HINGE	HAUZEN(DOM),POM,-,-,WHT,H	4	PC	SA
5-3	DC61-03189A	HINGE DOOR	WF8804DP,PA66,T5.0,Dark Holde	1	PC	SA
5-4	DC61-01915C	BRACKET-HOLDER	WD8754RJC/YL,GI-SGCC,T1.2	1	PC	SNA
5-5	DC64-01521A	DOOR GLASS	WF8804DP,GLASS,T5.0,H120.5,NA	1	PC	SA
5-6	6002-000445	SCREW-TAPPING	TH,+,NO,2,M4,L18,PASS,STS4	4	PC	SNA
5-7	DC63-00856C	COVER DOOR	WF1804WPC/XEU,ABS,T3.0,OD480,	1	PC	SA
5-8	DC97-15375J	ASSY HOLDER GLASS	HEBA,WF0804Y8E1/YLF	1	PC	SA
5-8-1	DC64-00564A	HANDLE PIN	Q1636GW/XEU,ST3,-,-,-,TS-	1	PC	SA
5-8-2	DC61-04909B	HOLDER GLASS	WF8804DPA,FP,T2.5,OD479.5,G	1	PC	SNA
5-8-3	DC61-02027A	SPRING-ETC LEVER	STAINLESS-STS304,CD1.2,	1	PC	SA
5-8-4	DC63-00853E	COVER HANDLE	HEBA,ABS,T2.5,Noble Gray,	1	PC	SA
5-8-5	DC64-01524C	HANDLE DOOR	HEBA,ABS,T2.5,Noble Gray	1	PC	SA
5-8-6	DC66-00497A	LEVER DCOR	WF8804DP,ZNDC,T10,W10,L46,NI	1	PC	SC
6	6009-001367	SCREW-HEX	LWH,+,M6.5,L32,ZPC(WHT),SWRC	16	PC	SNA
7	DC97-15021H	ASSY FRAME FRONT(S)	HEBA-PJT,WF8804DPA/X	1	PC	SNA
7-1	DC60-00018A	RIVET PLATE	MSWR-SWRH,D4,L43,WHT	4	PC	SNA
7-2	DC61-02919A	FRAME FRONT	WF8804HPA,EGI-SECC,T0.8	1	PC	SNA
7-3	DC61-01981A	BRACKET FRAME	WF8804DP,GI-SGCC,T0.8,W20,	1	PC	SNA
8	DC91-12078D	ASSY WIRE DIAPHRAGM	HEBA-PJT,-,-,-,-,-	1	PC	SA
9	DC63-00967A	COVER DOOR SWITCH	AEGIS-PJT/WF3500NHW,P	1	PC	SA
10	6002-000445	SCREW-TAPPING	TH,+,NO,2,M4,L18,PASS,STS4	4	PC	SNA

1-5. PANEL-CONTROL & DRAWER

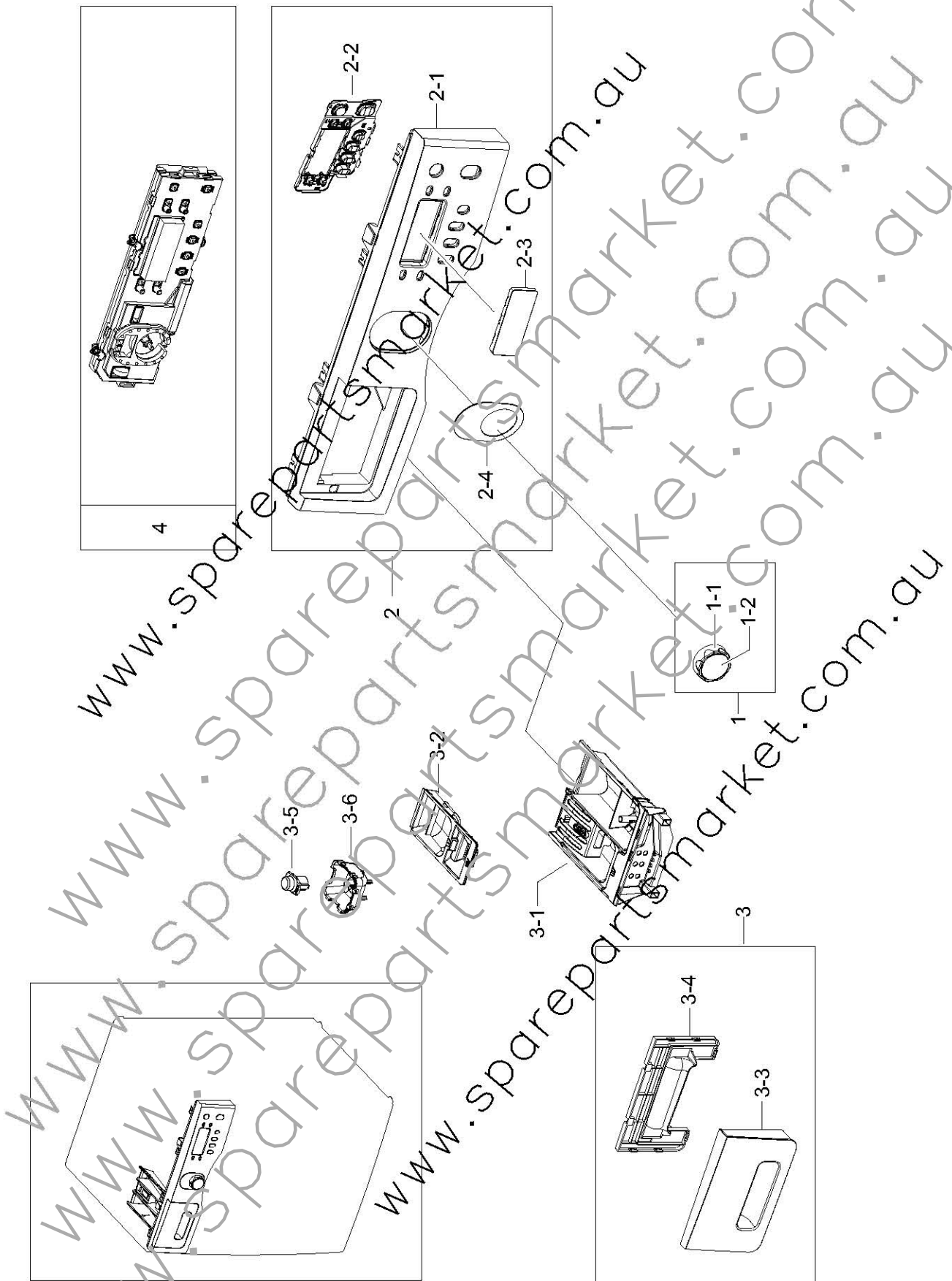

**MODEL CODE: WF1752WPC/XSA**

Service Bom (SA: SERVICE AVAILABLE, SNA: SERVICE NOT AVAILABLE)

Drawing No.	Code No.	Description	Specification	QTY	Un	SA/SNA
1	DC97-17357A	ASSY KNOB ENCODER	SEINE/BAIKAL/VOLGA	1	PC	SA
1-1	DC64-02900A	KNOB ENCODER	SEINE-PJT,ABS,SPARKING META	1	PC	SNA
1-2	DC64-02800A	DECORATION ENCODER	BAIKAL-PJT,ABS,T2.5,N	1	PC	SNA
2	DC97-17094L	ASSY PANEL CONTROL	VISTULA,WF1752WPC/XSA	1	PC	SA
2-1	DC64-01528A	PANEL CONTROL	HEBA-PJT,ABS,-,HG-0760GPD	1	PC	SNA
2-2	DC64-02698A	BUTTON PUSH-FUNCTION	HEBA,ABS,WHT	1	PC	SNA
2-3	DC64-01531A	WINDOW PANEL	HEBA-PJT,ABS,T2.0,-,-,BLK	1	PC	SNA
2-4	DC64-01533A	WINDOW ENCODER	HEBA,ABS,T2.0,-,-,BLK,H	1	PC	SNA
3	DC97-16500C	ASSY PANEL DRAWER	VISTULA,WF1702WPC/XEU,	1	PC	SA
3-1	DC61-03129A	BODY DRAWER	WF1802XEC/YLP,PP,T2.0,WHT,VO	1	PC	SA
3-2	DC67-00452A	CAP RINSE	WF0800NCE,PP,W65.4,L219.2,ECC	1	PC	SNA
3-3	DC64-01526A	PANEL DRAWER	HEBA-PJT,ABS,T2.5,W183.8,L1	1	PC	SNA
3-4	DC64-01527A	HANDLE DRAWER	HEBA-PJT,ABS,T2.0,WHT	1	PC	SNA
3-5	DC67-00524A	CAP DRAWER	WF0804Y8E/XEF,PP,T2.0,W27,L43	1	PC	SA
3-6	DC61-02581A	GUIDE LIQUID-MIDDLE	WF1802XEC,PP,T2.0,W6	1	PC	SA
4	DC92-00657K	ASSY PCB MAIN	Vistula main,7kg,1200rpm	1	PC	SA

1-6. ASS'Y HOUSING DRAWER

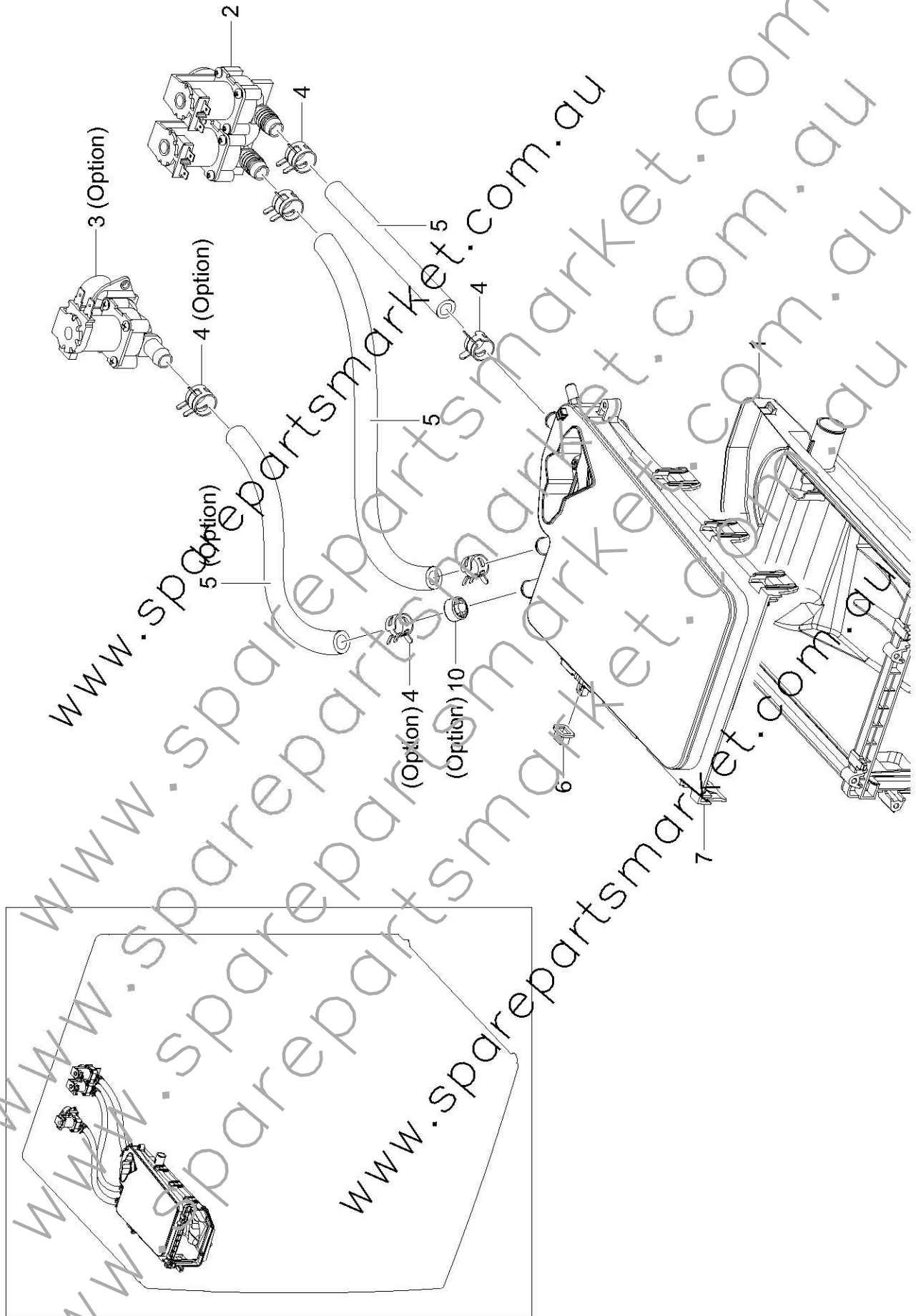

**MODEL CODE: WF1752WPC/XSA**

Service Bom (SA: SERVICE AVAILABLE, SNA: SERVICE NOT AVAILABLE)

Drawing No.	Code No.	Description	Specification	QTY	Un	SA/SNA
0	DC97-16005J	ASSY HOUSING DRAWER	VISTULA,WF1804WPC/XE	1	PC	SA
1	DC61-02434A	HOUSING DRAWER-LOW	HEBA-PJT,PP,T1.3,NATU	1	PC	SA
2	DC62-00024F	VALVE WATER	220-240,10,B-2	1	FC	SA
4	DC65-00008B	CLAMPER HOSE	SSEC-GE,SK5,ID14.2,ZPC2,T1.	4	PC	SNA
5	DC67-00051B	HOSE DRAWER	Q1636GW/XEU,EPDM,ID9.0,OD14.	0.42	M	SNA
6	DC67-00327A	CAP DRAWER HOOK	HEBA-PJT,EPDM,T1.1,W13.9	1	FC	SNA
7	DC97-16006A	ASSY S.HOUSING DRAWER	SCOUT,WF080478E,PP	1	PC	SNA

**1-7. OTHER CODE (SA/SNA) : WF1752WPC/XSA**

Service Bom (SA: SERVICE AVAILABLE, SNA: SERVICE NOT AVAILABLE)

Drawing No.	Code No.	Description	Specification	QTY	Un	SA/SNA
W0636	DC97-16460J	ASSY SEMI TUB FRONT	Heba,WF0704W7V1/XST,	1	PC	SA
G0048	DC97-16478D	ASSY TUB FRONT	Heba,WD0804W8N4/YAH,8.0KG	1	PC	SC
M0030	DC97-14006C	ASSY SCREW	GRIFFIN-PJT,WF9904RWE,SWRCH10	2	PC	SA
G0425	6009-001522	SCREW-HEX	HWH,+ M5,L16,PASS,STS450,FP,SE	2	PC	SA
W0754	DC61-01915B	BRACKET HOLDER	WF8604DP,GI-SGCC,T1,2,N/A	1	PC	SA

**1-8. PARTS LIST (SCREW TYPE)**

**MODEL CODE: WF1752WPC/XSA**

Service Bom (SA: SERVICE AVAILABLE, SNA: SERVICE NOT AVAILABLE)

SVC Code	Code No.	Description	Specification	QTY	Un	SA/ SNA
W0105	6002-000445	SCREW-TAPPING	TH,+,NO,2,M4,L18,PASS,STS4	4	PC	SNA
W0105	6002-000520	SCREW-TAPPING	TH,+,-,2,M4,L12,ZPC(WHT),S	1	PC	SNA
G0425	6009-001367	SCREW-HEX	HWH,+,-,M6.5,L32,ZPC(WHT)SWRC	16	PC	SNA
W0105	6002-000445	SCREW-TAPPING	TH,+,NO,2,M4,L18,PASS,STS4	2	PC	SNA
	6002-001554	SCREW-TAPPING	TH,+,No,1,M4,L12,STS430,HE	2	PC	SNA
F0056	6003-001768	SCREW-TAPTYRE	TH,+,WT,S,M4,L10,ZPC(WHT),	1	PC	SNA
W0105	6002-001006	SCREW-TAPPING	TH,+,,-,2S,M4,L12,PASS,STS4	3	PC	SNA
W0105	6002-000445	SCREW-TAPPING	TH,+,NO,2,M4,L18,PASS,STS4	2	PC	SNA
W0105	6002-000520	SCREW-TAPPING	TH,+,-,2,M4,L12,ZPC(WHT),S	1	PC	SNA
W0105	6002-001438	SCREW-TAPPING	HWH,+,-,NC,1,M5,L12,ZPC(WHT)	2	PC	SNA
W0105	6006-001174	SCREW-TAPPING	TH,+,WE,2S,M4,L12,ZPC(WHT)	4	PC	SNA
W0102	6009-001343	SCREW-SPECIAL	PH,1TORX,M4,L12,ZPC(WHT),SW	1	PC	SNA
W0105	6002-001436	SCREW-TAPPING	PH,+,-,2,M4,L18,ZPC(WHT),SWR	6	PC	SNA
	6003-001563	SCREW-TAPTYRE	TH,+,S,M4,L8,N PLT,SWRCH1	2	PC	SNA
W0105	6002-000520	SCREW-TAPPING	TH,+,-,2,M4,L12,ZPC(WHT),S	4	PC	SNA
F0056	6003-001768	SCREW-TAPTYRE	TH,+,WT,S,M4,L10,ZPC(WHT),	2	PC	SNA
W0105	6006-001174	SCREW-TAPPING	TH,+,WE,2S,M4,L12,ZPC(WHT)	5	PC	SNA
W0105	6002-001327	SCREW-TAPPING	PWH,+,-,1,M4,L12,ZPC(WHT),SW	6	PC	SNA
W0105	6006-001174	SCREW-TAPPING	TH,+,WE,2S,M4,L12,ZPC(WHT)	2	PC	SNA
W0105	DE60-10080A	SCREW-TAPPING	PWH,+,-,2S,M5,L9,-,SWRCH18	2	PC	SNA
W0105	6002-000520	SCREW-TAPPING	TH,+,-,2,M4,L12,ZPC(WHT),S	4	PC	SNA
	6002-001554	SCREW-TAPPING	TH,+,No,1,M4,L12,STS430,HE	2	PC	SNA
G0425	6009-001522	SCREW-HEX	HWH,+,-,M5,L16,PASS,STS430,FP,SE	2	PC	SA
	6002-001554	SCREW-TAPPING	TH,+,No,1,M4,L12,STS430,HE	12	PC	SNA
W0105	6002-000445	SCREW-TAPPING	TH,+,NO,2,M4,L18,PASS,STS4	4	PC	SNA
	6002-000440	SCREW-TAPPING	HWH,+,-,2,M3,L8,ZPC(BLK),SWR	2	PC	SNA
G0010	6003-000269	SCREW-TAPTYRE	BH,+,-,S,M3,L6,ZPC(WHT),SW	2	PC	SNA